

Missouri Mappers Association

34th Annual Conference

Making Waves in Mapping

August 7th - 10th, 2018

Oasis Hotel & Convention Center

Springfield, MO

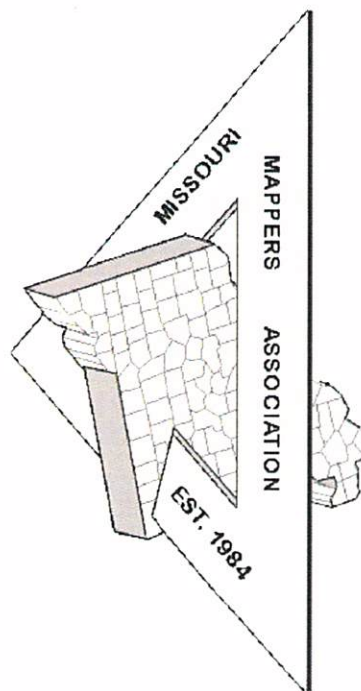

TABLE OF CONTENTS

2. Table of Contents
3. Corporate Sponsorship
4. Meeting Rooms Map
5. Directions to Andy B's
6. Conference Schedule
7. Conference Schedule - cont.
8. Wednesday Workshops
9. Keynote Speaker
10. Thursday Presentations
11. Thursday Presentations - cont.
12. Exhibitors
13. Awards
14. Officers
15. Committees
16. MMA Membership List
17. MMA Membership List - cont.
18. MMA Membership List - cont.
19. MMA Chapter Map

**A SPECIAL THANKS TO OUR
2018 CORPORATE SPONSORS**



MIDLAND
GIS Solutions



SEILER
GEOSPATIAL DIVISION

www.seilergeo.com



SURDEX
CORPORATION

CONVENTION CENTER MAP

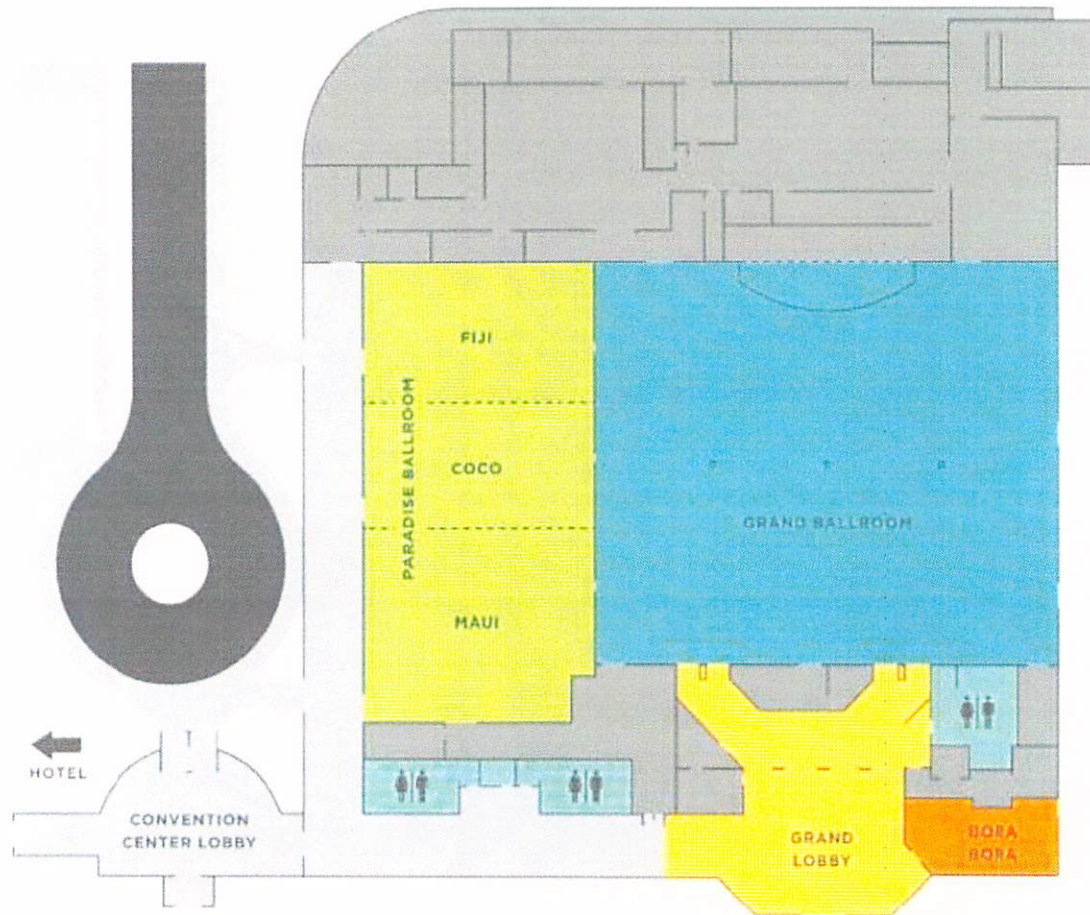

PROPERTY MAP

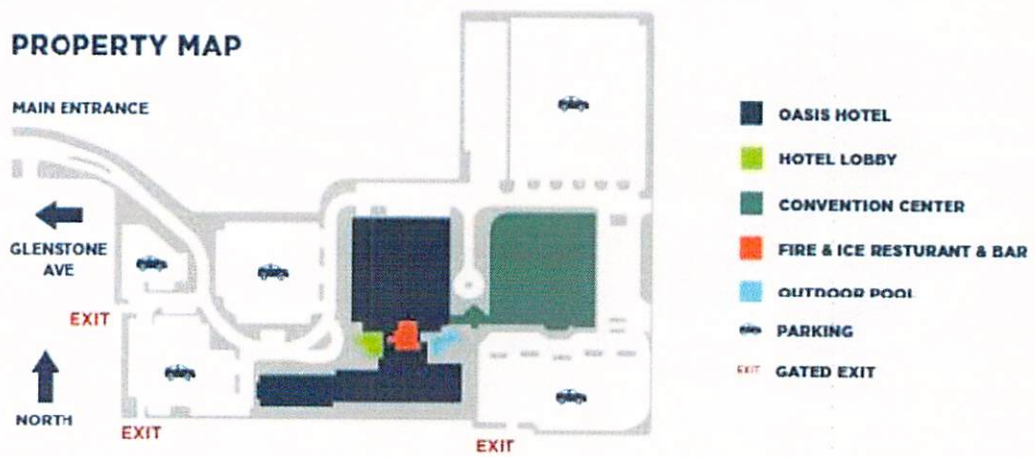

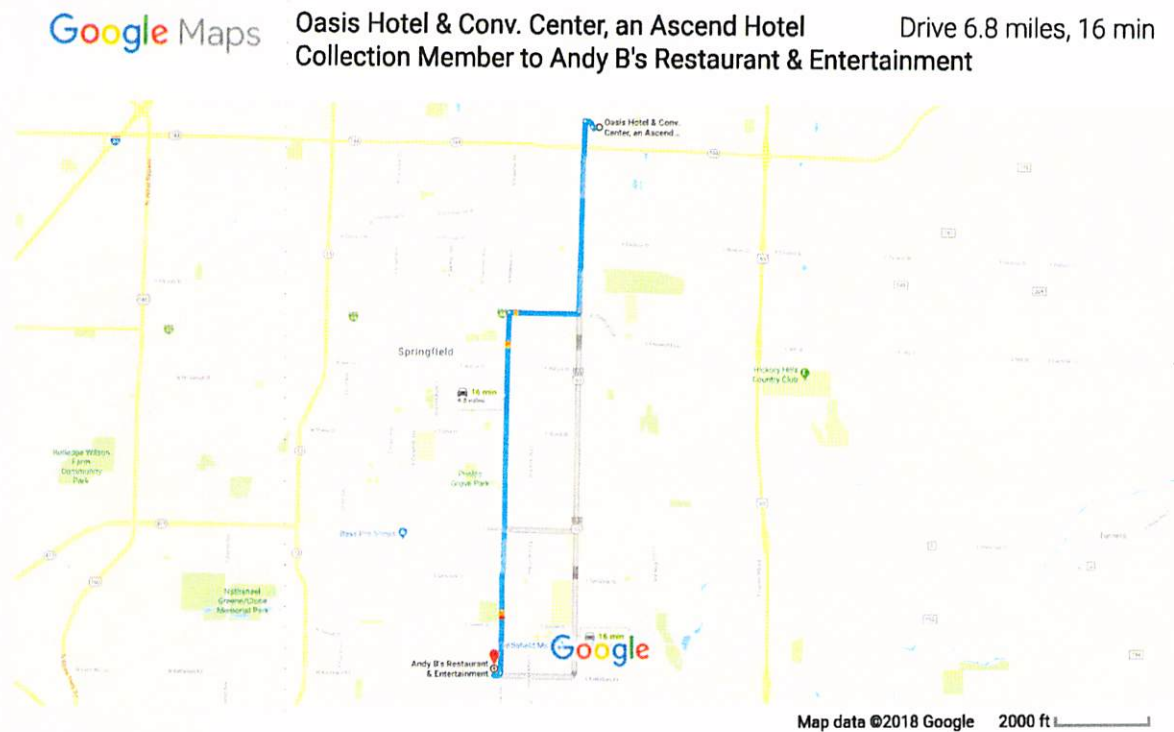

Oasis Hotel & Conv. Center, an Ascend Hotel Collection Member

2546 N Glenstone Ave, Springfield, MO 65803

1. Head southwest 285 ft
2. Slight right toward Glenstone Ave 0.1 mi
3. Turn left onto Glenstone Ave
Pass by Sonic Drive-In (on the left in 1.1 mi) 2.0 mi
4. Turn right onto E Chestnut Expy
Pass by Arvest Bank (on the right in 0.7 mi) 0.8 mi
5. Use the left 2 lanes to turn left onto N National Ave
Pass by Taco Bell (on the right in 3.7 mi) 3.8 mi
6. Turn right onto E Battlefield Rd 436 ft

Andy B's Restaurant & Entertainment

1127 E Battlefield Rd, Springfield, MO 65807

2018 MMA Conference Schedule

Tuesday, August 7, 2018

- 4:00 P.M. - 5:30 P.M. **Registration Open - Glass Lobby**
- 5:30 P.M. - 7:30 P.M. **Welcome Reception - Sahara Room**
Food and non-alcoholic beverages provided

Wednesday, August 8, 2018

- 7:30 A.M. - 8:30 A.M. **Registration Open - Glass Lobby**
- 8:30 A.M. - 11:30 A.M. **Workshop - Introduction to ArcGIS Pro Workshop**
Fiji Ballroom- Ken Wilkerson, GISEDGE, INC
- Break @ 10 A.M.*
- 8:30 A.M. - 11:30 A.M. **Workshop - GIS: collection to analysis to final product**
Coco Ballroom- Kristen Wenzel TREKK Design Group, LLC
- Break @ 10 A.M.*
- 11:30 A.M. - 1:00 P.M. **Lunch on your own**
- 1:00 P.M. - 4:00 P.M. **Workshop - Getting Started with ModelBuilder**
Fiji Ballroom- Ken Wilkerson, GISEDGE, INC
- Break @ 2:30 P.M.*
- 4:30 P.M. - 5:30 P.M. **Registration Open - Glass Lobby**
- 5:30 P.M. - 7:30 P.M. **Vendor Reception - Maui Ballroom**
- 8:00 P.M. - Midnight **Andy B's Entertainment - Bowling/Arcade**

Thursday, August 9th, 2018

- 7:30 A.M. - 8:00 A.M. **Registration Open - Glass Lobby**
- 8:00 A.M. - 9:00 A.M. **Breakfast Buffet - Maui Ballroom**
Tables will be reserved for our PMM's
- 9:00 A.M. - 9:45 A.M. **Presidential Welcome - Fiji Ballroom**
Key Note Speaker - Christopher Dunn
- 9:45 A.M. - 10:30 A.M. **The Canary Project - Fiji Ballroom**
Ryan Hunt, City of Springfield GIS
Jordan Coiner, Springfield-Greene Co Health Dept
- 10:30 A.M. - 10:45 A.M. **Morning Break with Exhibitors - Maui Ballroom**

- 10:45 A.M. - 11:30 A.M. **Herrmann Brain Dominance Instrument - Fiji Ballroom**
Karla Deaver, 4-H Youth Development Specialist, MU Extension
- 11:30 A.M. - 12:15 P.M. **ESRI Survey123 - Fiji Ballroom**
Joe Madej, Seiler Instruments
Carol Burnis, Seiler Instruments
- 12:15 P.M. - 1:30 P.M. **Lunch, Chapter Meetings, Door Prizes - Maui Ballroom**
- 1:30 P.M. - 2:15 P.M. **GeoSTRAT - Fiji Ballroom**
Vicki Voight - Missouri Department of Natural Resources
- 2:15 P.M. - 3:00 P.M. **Python-Next Level: User Interface, Error Logging &
Configuration Files - Fiji Ballroom**
Robert Meier - TREKK Design Group, LLC
- 3:00 P.M. - 3:15 P.M. **Afternoon Break with Exhibitors - Maui Ballroom**
- 3:15 P.M. - 4:00 P.M. **UAS Mapping - Fiji Ballroom**
Steve Kasten, Surdex Corporation
- 4:00 P.M. - 4:45 P.M. **Henry Rowe Schoolcraft's Exploration into the Ozarks - Fiji Ballroom**
Curtis Copeland, City of Branson
- 6:00 P.M. - 7:00 P.M. **Dinner - Maui Ballroom**
- 7:00 P.M. - 9:00 P.M. **Poolside Beach Party with DJ Zach Lee**
Don't miss it!!! Games & Prizes

Friday, August 10, 2018

- 8:00 A.M. - 9:00 A.M. **Breakfast Buffet - Fiji Ballroom**
- 9:00 A.M. **Annual Business Meeting - Fiji Ballroom**
Presentation of Awards, Election of Officers
Special Conference Survey Participant Drawing



2018 Missouri Mappers Association Conference

Wednesday Workshops August 8th

Introduction to ArcGIS Pro Workshop – Ken Wilkerson, GISEDGE, Inc.

This workshop helps you get ready for your conversion to ArcGIS Pro. We'll see how to import map documents into ArcGIS Pro and how to perform many of the tasks you are familiar with in your daily use of ArcMap: working with symbology and layer properties, building queries, running tools, making a layout, etc.

GIS: Collection to Analysis to Final Product – Kristen Wenzel, TREKK Design Group, LLC

Through this workshop, we will be learning the benefits of using GIS, and understanding the process from start to finish. During the workshop, there will be field data collection, importing\exporting into GIS software, and learning different tools within the software to analyze what you collect. There are hundreds of programs out there for both the data collection side, as well as analysis. Together we will go through a few open source options, as well as the ESRI suite to get an overall understanding of what each program can do for you. In addition, we will cover a few new GIS technologies that have recently surfaced, and ones that are in the works. This presentation will not be specific to any one industry in order make sure every participant benefits from the workshop. Come with questions and figure out how GIS can fit for you!

Getting Started with ModelBuilder - Ken Wilkerson, GISEDGE Inc.

Esri ModelBuilder (MB) provides a visual programming environment for combining data and tools to automate tasks and create custom tools. This course will introduce MB processing with hands-on exercises demonstrating the creation of models ranging from simple to complex. You will learn how to quickly and effectively develop models that help you become more productive ArcGIS users.



2018 Missouri Mappers Association Conference

Keynote Speaker, Thursday August 9th

Keynote Speaker- Christopher Dunn

Chris Dunn is a veteran, business owner, practicing attorney, and expert geospatial witness. He holds a Juris Doctor from the University of Missouri – School of Law, Columbia as well as a Masters and Bachelors in geography from Kansas State University. His firm GeoVelo, LLC, uses Geographic Information Systems (GIS) and 3-D modeling software to make special purpose maps and 3-D digital crime scene reconstructions. Chris's favorite projects involve mapping and documenting complex, long-standing, property boundary conflicts. Past projects have required authenticating the boundaries and the chain of title to a time before Missouri's statehood. Prior to law school, Chris had a 20-year career as the director of several planning, zoning and community development departments. Prior to that, Chris spent some time overseas as an Explosive Ordnance Disposal (EOD) technician defusing IED's, and generally making a mess out of some very bap people's arms stockpiles and critical infrastructure. Chris regularly gives presentations on geospatial legal issues. He is a father, grandfather, member of the Missouri Bar, Eagle Scout, has won awards for his urban planning, filmmaking, and pro-bono legal work. More information is available at www.MoGovtLaw.com or www.GeoVelo.org



2018 Missouri Mappers Association Conference

Thursday Presentations August 9th

The Canary Project- Ryan Hunt & Jordan Coiner

Using public data from a variety of sources to complete a wide spectrum analysis of health and social factors to share with project and community partners using the ArcGIS Online Story Map platform as a sharable and presentable repository of this analysis and findings. I will be presenting on the GIS side of things, both analysis and setting up Story Maps. Jordan will be discussing the Health Dept side of the project with use cases, project reach, and some data methodology.

Ryan Hunt is a Senior GIS Specialist with the City of Springfield. He has worked with the City full time for a little over 2 years now. Prior to that Ryan was with an engineering consulting firm out of Joplin Mo for 2 years working on his own client base in training and GIS maintenance. Ryan graduated with a BS in Geology with a minor in GIS from Missouri State University in 2014.

Jordan Coiner is a Performance Management and Data-Driven Decision Making Specialist. He has worked at the Springfield-Greene County Health Department for nearly four years. Jordan graduated from Missouri State University in 2014 with a BS in Biology and a minor in Chemistry. His main focus is to encourage data-driven decision making in the department and community.

Herrmann Brain Dominance Instrument- Karla Deaver

For some, taking the HBDI[®] suddenly identifies a lifetime pattern of personal and professional choices. For others, it sends signals as to which area of interpersonal growth cries out for development. And yet others find that HBDI[®] results lend insight to the inner workings of past and current relationships with family members and friends. Karla's presentation will focus on getting to know ourselves and our thinking styles.

Karla Deaver is a 4-H Youth Development Specialist with University of Missouri Extension, headquartered in Lawrence County. She holds a M.S. in Dairy Science from the University of Missouri-Columbia, and a B.S. in Dairy Science from Missouri State University. Karla is a certified practitioner of the Herrmann Brain Dominance Instrument, a quick, easy-to-take survey that registers and interprets thinking preferences.

ESRI Survey123 - Joe Madej & Carol Burnis

Carol and Joe will be talking about ESRI Survey123. They will be talking about how to turn your paper form into a usable crowdsourced data collection form.

Carol Burnis has over 10 years of experience in the GIS/Mapping industry in various roles. Previous to working for Seiler, she worked for a local municipality's Public Works, Planning and Parks departments performing field collection, data analysis, cartography, database design/maintenance, training and support. Before starting this role, Carol provided Mapping Technical Support to Seiler's customers across all markets and hopes to be a resource to our customers in this position as well.

Joe is a member of the Seiler Instrument Mapping Technical Support team in St Louis, MO. He serves in technical support and a Certified Trimble trainer of both Trimble mapping hardware and software. Prior to Seiler, Joe has spent his 10+ year GIS career working on Federal and Local Government projects, rural water line mapping, and field data collection. Joe holds a Bachelor's degree in Science with an Area of Specialization in GIS from Southern Illinois University Edwardsville. He also holds his GIS Professional Certification.

GeoSTRAT – Vicki Voight

RG, Chief, Geologic Mapping Unit, Missouri Department of Natural Resources, Missouri Geological Survey.

Python - Next Level: User Interface, Error Logging, Configuration Files – Robert Meier

This presentation will introduce Tkinter, the most popular GUI library for Python. You will learn how to create basic forms with buttons, labels, text boxes and list boxes, as well as, call message, file and folder dialogs.

For lengthy and complicated scripts, error catching and logging can be an important debugging tool, you will be shown how to create a log file, catch errors and log different messages.

Configuration files can add versatility to a script, instead of hard coding values in your code, read them from a configuration file. Holding values (file paths, field names, text values, etc.) in a configuration file specific to a process or client, can make one script usable for multiple jobs.

Robert “Bert” Meier has been a GIS professional for over 25 years. He has experience ranging from data creation to application development. He has worked in municipal government and private industry where he provided GIS services to public works, water, wastewater and rail clients. He is an expert in most ESRI software and an experienced developer using, C#, VB, JavaScript and Python. Currently with TREKK Design Group, Bert is using his programming skills to automate Sanitary Sewer Evaluation Studies and MACP data processes.

UAS Mapping - Steve Kasten

UAS mapping has become a popular topic today for GIS professionals. Many GIS users are making use of imagery and mapping data extracted from UAS imagery. As the software for these applications has developed, we have seen various levels of accuracy and precision being created. This presentation will address some of the issues associated with the collection, processing and exploitation of UAS imagery and present techniques to assess and assure the quality of the data produced.

Steve Kasten has over 35 years of experience in the fields of photogrammetric engineering application development, photogrammetric mapping, geodesy, cartography and surveying. While at Surdex, Steve has performed disparate duties that include the management of photogrammetric projects, airborne GPS survey data and triangulation. In addition to his extensive project management experience, Steve has experience providing direct photogrammetric engineering support services. He is skilled in developing algorithms for sensor modeling, post processing of GPS data, error propagation, photogrammetric data reduction, and implementing algorithms into engineering programs.

Henry Rowe Schoolcraft’s Exploration into the Ozarks – Curtis Copeland

In recognition of the bicentennial of Henry Rowe Schoolcraft’s exploration into the Ozarks in 1818-1819, as well as provide an educational tool and geographic reference of the journey, Curtis Copeland has created digital, spatial mapping data of the route, and created an interactive, web map application. Copeland has utilized modern Geographic Information Systems (GIS) technology to add more specific detail and refine the general maps first created by Dr. Milton Rafferty several years ago. GIS allows for the spatial analysis of multiple geographic resources and digital maps to identify historic landmarks, landforms, topographic and hydrographic features. Digital maps resources such as historical USGS topographic maps, GLO survey maps, digital elevation models, and digital aerial photography is georeferenced and analyzed. This spatial data, when compared to Schoolcraft’s journal entries and descriptions of the locations and terrain he traveled, has been utilized to add detail to the predefined route map established by Dr. Rafferty.

The resulting digital route has been utilized by Copeland in the development of an interactive web mapping application. This application includes not only Schoolcraft’s route, but also includes map points for his campsites and points of interest.

Curtis Copeland is currently the Geographic Information Systems Coordinator for the City of Branson, Missouri, and has held this position for almost 20 years. Curtis has had a lifelong interest in Ozarks history and culture, and feels that Schoolcraft’s journal entries are an excellent source of information and a window to a time before the Ozarks were heavily impacted by European settlers, evidence of Native American activities were still prominent, and descriptions of the geography, flora and fauna, and the daily lives of the earliest pioneers were well described.

EXHIBITORS

ClearBasin Software **Representative: Andy Terry and Aaron Lemmon**

P.O. Box 5870
Springfield, MO 65801
Tel: 417-770-7709 Email: andy@clearbasin.com
www.clearbasin.com



GISEDGE, Inc. **Representative: Ken Wilkerson**

290 Tait Ter SE
Port Charlotte, FL 33952
Tel: 941-585-1423 Email: ken@gisedge.com
www.gisedge.com



Midland GIS Solutions **Representatives: Katie Shepherd and Matt Sorensen**

501 N. Market
Maryville, MO 64468
Tel: 660-562-0050 Email: shepherd@midlandgis.com
www.midlandgis.com



Seiler Instrument Company **Representatives: Joe Madej and Carol Burnis**

3433 Tree Court Ind. Blvd.
St. Louis, MO 63122
Tel: 314-218-6339 Email: jmadej@seilerinst.com
www.seilerinst.com



Springfield Blue Print **Representative: Tiffany Rogers**

219 E. Pershing St.
Springfield, MO 65806
Tel: 417-869-7316 Email: trogers@spfdbblue.com
www.spfdbblue.com



Surdex Corporation **Representative: Tim Donze and Steve Kasten**

520 Spirit of St. Louis Blvd.
Chesterfield, MO 63005
Tel: 636-368-4400 Email: timd@surdex.com
www.surdex.com



2017 AWARD WINNERS

Congratulations to each of our Award Winners in 2017 for their outstanding contribution to MMA!

Mapper of the Year

Christine McKinney

Fireball

Katrina Williams

Boss of the Year

Laura Pope

Annual Meeting Award

Sue Ann Stokes

President Award

Carla Palmer



2017 - 2018 MMA OFFICERS

PRESIDENT

Brenda Dryer
Lawrence County
lcmoassessor@sofnet.com
417-466-2831

IMMEDIATE PAST PRESIDENT

Carla Palmer
Jasper County
cpalmer@jaspercounty.org
417-237-1042

PRESIDENT ELECT

Sue Ann Stokes
McDonald County
sueann.stokes@mcdonaldcountymo.gov
417-223-7405

SECRETARY

Tonja Friend
Taney County
tonjaf@co.taney.mo.us
417-546-7210

TREASURER

Lisa Perry
Jasper County
lperry@jaspercounty.org
417-237-1013

2017 - 2018 DIRECTOR

James Theisen
Pettis County
gis@pettisco.com
660-827-4800

2017 - 2019 DIRECTOR

Matt Sorensen
Midland GIS Solutions
sorensen@midlandgis.com
660-562-0050

2017 - 2018 COMMITTEES

ANNUAL MEETING

Sue Ann Stokes - Chair
Brenda Dryer - Co-Chair
Lisa Perry
Danielle Orf
Lisa Mendpara
Alice Lee
Carla Palmer
Lora Miller
Cyndee Schmidt
Kristen Wenzel
Amanda Bybee

AWARDS

Alice Lee - Chair
Tiffany Rogers - Co-Chair
Laura Cole
Lisa Mendpara

CERTIFICATION

Tim Kean - Chair
Stan Balsman
Marti Suiter
Stephanie Hyder-Stevens
Alice Lee

EDUCATION

Katrina Williams - Chair
Cyndee Schmidt
Brenda Dryer
Amanda Bybee

HISTORICAL

Katrina Williams - Chair

MEDIA

Amanda Bybee - Chair
Kristen Wenzel
Melissa Johnson

MEMBERSHIP

Marti Suiter - Chair
Sarah Anderson
Arron Kettle
Kristen Wenzel
Lora Miller

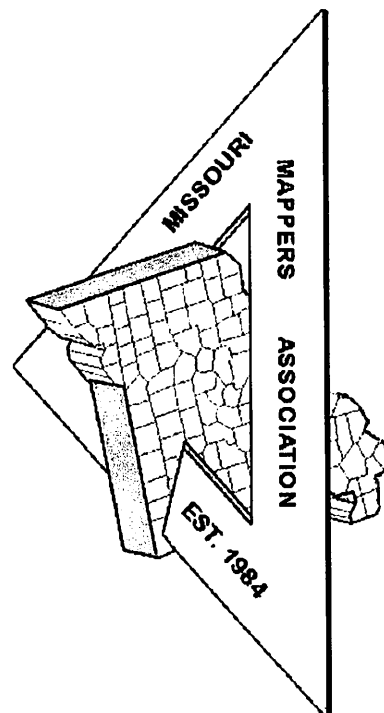

<u>Name</u>	<u>Entity</u>	<u>Phone</u>	<u>Email</u>
Alexander, Patsy	Taney County	417-546-7210	patsya@co.taney.mo.us
Anderson, Sarah	Cape Girardeau County	573-204-2505	snanderson@capecounty.us
Baker, Brett	Aerial Surveys Intl.	816-582-6727	bbaker@aerialsurveysintl.com
Balsman, Stan	SEMO Regional Planning	573-547-8357	swbalsman@semorpc.com
Berry, Jama	Ozark County	417-844-7685	ozarkcountvassessor1@yahoo.com
Boltz, Celest	Adair County	660-785-3210	cboltz@adaircomo.com
Boschert, Deborah	USDA	573-876-0906	deborah.boschert@mo.usda.gov
Bowerman, Doug	Lawrence County	417-466-2831	lcmoassessor@sofnet.com
Boyer, Bob	Jefferson County	636-797-5396	jancell@jeffcomo.org
Burnis, Carol	Seiler Instrument	314-218-6339	cburnis@seilerinst.com
Bybee, Amanda	TREKK Design Group	417-209-0588	abybee@trekkdesigngroup.com
Cole, Laura	Jefferson County	636-797-5396	lcole@jeffcomo.org
Cooley, Nathan	Pioneer Trails RPC	660-463-7934	nathan@trailsrc.org
Cunningham, Sara	Pike County	573-324-6136	sara@pikecounty-mo.gov
Davis, Jeff	Boone County	573-886-4262	jdavis@boonecountymmo.org
Donze, Tim	Surdex Corporation	636-532-3427	timd@surdex.com
Dorsey, Kathy	Taney County	417-546-7242	assessor@co.taney.mo.us
Dryer, Brenda	Lawrence County	417-229-1166	gagermann_bristol64@yahoo.com
Eastman, Frank	Cooper County	660-882-2646	
Edgar, Danny	St. Francois County	573-756-1878	dedgar@sfcgov.org
Eisterhold, Cameron	Callaway Electric Coop.	573-826-2325	ceisterhold@callawayelectric.com
Fisher, Chase	Jasper County	417-237-1015	cfisher@jaspercountymmo.gov
Friend, Tonja	Taney County	417-546-7210	tonia.friend@co.taney.mo.us
Godfrey, Billie	Cass County	816-380-8124	billieg@casscountv.com
Hallowell, Shane	City of Higginsville	816-341-0337	gis@ctcis.net
Huffman, Kortney	City of Springfield	417-864-1982	khuffman@springfieldmo.gov
Hurlbert, Roger	Sage Information Services	573-632-2300	sage1@pacbell.net
Huston, Bob	Cass County	816-380-8124	bobh@casscountv.com
Hyder-Stevens, Stephanie	State Tax Commission	417-464-0192	shyderstevens@hotmail.com
James, Debbie	Texas County	417-967-4709	assessor@texascountymissouri.gov
Jones, Larry	Buchanan County	816-271-3477	liones@co.buchanan.mo.us
Kasten, Steve	Surdex Corporation	636-368-4400	stevek@surdex.com
Kaszuba, Barbara	Jasper County (retired)	417-483-1853	bakaszuba@gmail.com
Kean, Tim	Phelps County	573-458-6135	tim.kean@phelpscounty.org
Kettle, Arron	Callaway County	573-642-0768	ahudson@callawaycounty.org

Kramer, Richard	City of Jackson	573-243-2300	rkramer@jacksonmo.org
Landtiser, Sarah	Hickory County	417-745-6346	assessor@hickorycountymmo.org
Lee, Alice	Jefferson County	636-797-5396	alee@jeffcomo.org
Lemmon, Aaron	ClearBasin Software	417-770-7709	darcey@clearbasin.com
Lenshyn, Becky	Camden County	573-346-4440	beckylenshyn@camdenmo.org
Lloyd, Michael	Camden County	573-317-6106	m.lloyd@camdenso-mo.us
Madej, Joe	Seiler Instrument	314-218-6339	jmadej@seilerinst.com
McCutcheon, John "Woody"	Howard County	660-248-3400	hocoass@yahoo.com
McKinney, Christine	Pettis County	660-826-5000	mckinneyc@pettisco.com
Meier, Robert	TREKK Design Group	816-877-8674	rmeier@trekkdesigngroup.com
Mendpara, Lisa	Cass County	816-380-8190	lisac@casscounty.com
Miller, Lora	Vernon County	417-448-2530	lmiller@vernoncountymmo.org
Mitchell, Brad	Missouri Geological Survey	573-368-2116	brad.mitchell@dnr.mo.gov
Morgan, Anthony	MO DOT	573-355-2199	tonymo1976@hotmail.com
Noppe, Paula	Cape Girardeau County	573-204-2506	pfnoppe@capecounty.us
Orf, Danielle	Pike County	573-324-3261	dno@pikecounty-mo.gov
Palmer, Carla	Jasper County	417-237-1042	cpalmer@jaspercounty.org
Paschal, Jody	Callaway County	573-642-0768	jpaschal@callawaycounty.org
Perry, Lisa	Jasper County	417-237-1013	lisap@ecarthage.com
Pittman, Cody	Lafayette County	660-259-6158	c.pittman@lafayettecountymmo.com
Raff, Jared	MO DOT	954-675-7884	jared.raff@modot.mo.gov
Ray, Tina	Cooper County	660-882-2646	deputyassessor@coopercountymmo.gov
Reiter, Gerald	Camden County	573-280-9348	jr.reiter@camdenso-mo.us
Ribble, Donna	Jefferson County	636-797-5396	dribble@jeffcomo.org
Roe, Dan	State Tax Commission	573-592-9738	dwroe@outlook.com
Rogers, Tiffany	Springfield Blue Print	417-869-7316	trogers@spfdblue.com
Rohter, Jacob	MDNR	573-368-2486	jacob.rohter@dnr.mo.gov
Schmidt, Cyndee	Kaysinger Basin RPC	660-885-3393	cschmidt@kaysinger.com
Schmitz, Trish	Jefferson County	636-797-5396	pschmitz@jeffcomo.org
Shepherd, Katie	Midland GIS Solutions	660-562-0050	shepherd@midlandgis.com
Sorensen, Matt	Midland GIS Solutions	660-562-0050	sorensen@midlandgis.com
Sorenson, Amy	Taney County	417-546-7242	assessor@co.taney.mo.us
Stokes, Sue Ann	McDonald County	417-223-4361	sueann.stokes@mcdonaldcountymmo.gov
Suiter, Marti	Hickory County	417-745-6346	martisuiter@aol.com
Terry, Andy	ClearBasin Software	417-770-7709	darcey@clearbasin.com
Theisen, James	Pettis County	660-827-4800	gis@pettisco.com

Volkart, Diedra	Callaway County	573-680-1769	dvolkart@yahoo.com
Wadel, Shelby	Vernon County	417-448-2530	swadel@vernoncountymo.org
Waybill, Donnie	Adair County	660-216-6941	dwaybill@adaircomo.com
Wenzel, Kristen	TREKK Design Group	314-920-5352	kwenzel@trekkdesigngroup.com
Wilkerson, Ken	GISEDGE, Inc	941-585-1423	ken@gisedge.com
Wilson, Gaila	Camden County	573-346-4440	gaila_wilson@camdenmo.org
Woolery, Christopher	Pettis County	660-826-5000	wooleryc@pettisco.com
York, Amy	Christian County	417-582-4310	ayork@christiancountymo.gov

Missouri Mappers Association Chapters

Map date: July 14, 2016

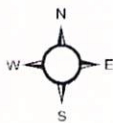
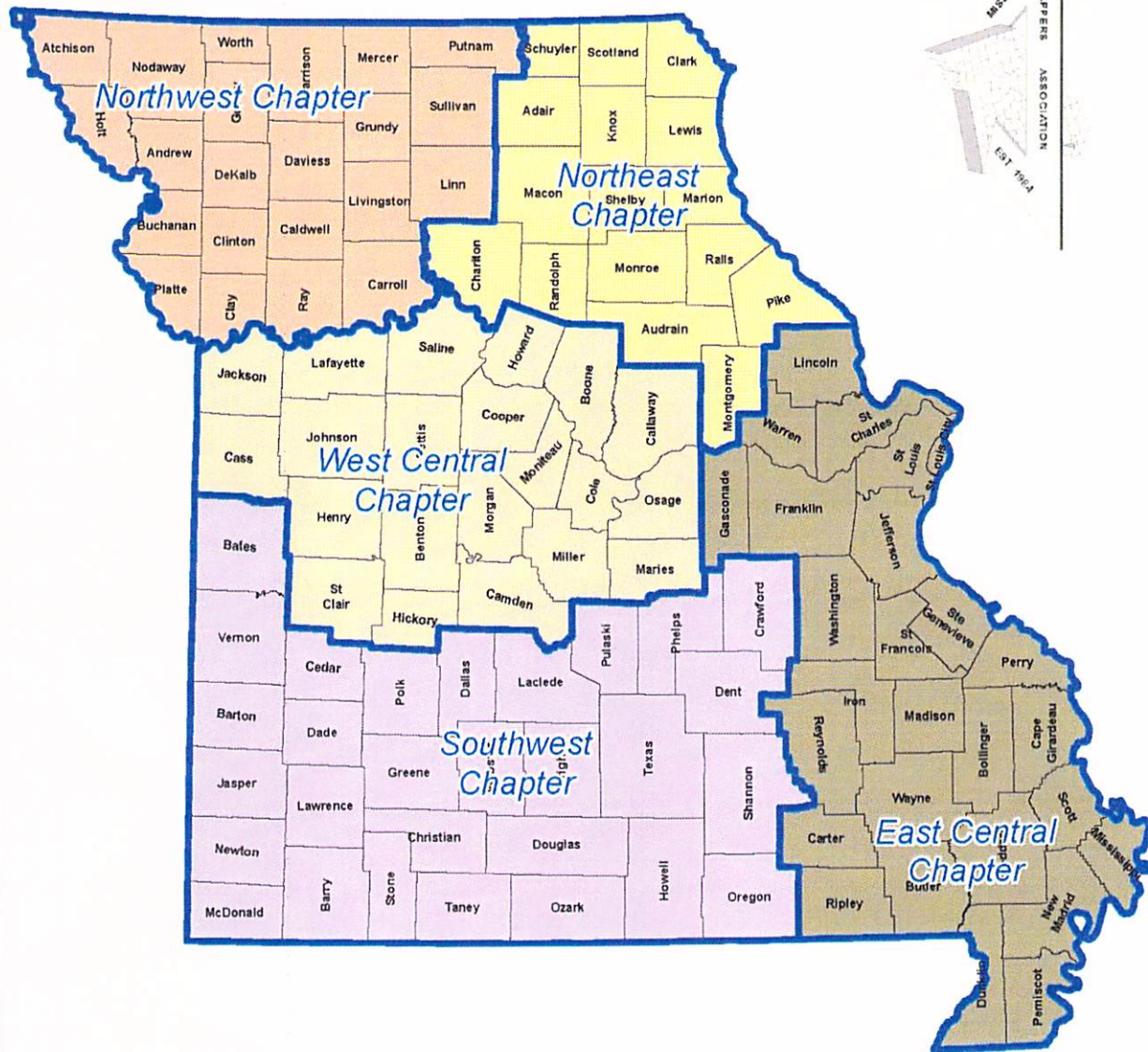

MISSOURI MAPPERS ASSOCIATION

Thanks you for your support!

