

Missouri Mappers Association

33rd Annual Conference

Go "All In" With Your Mapping

August 1st - 4th, 2017

Capitol Plaza Hotel & Convention Center

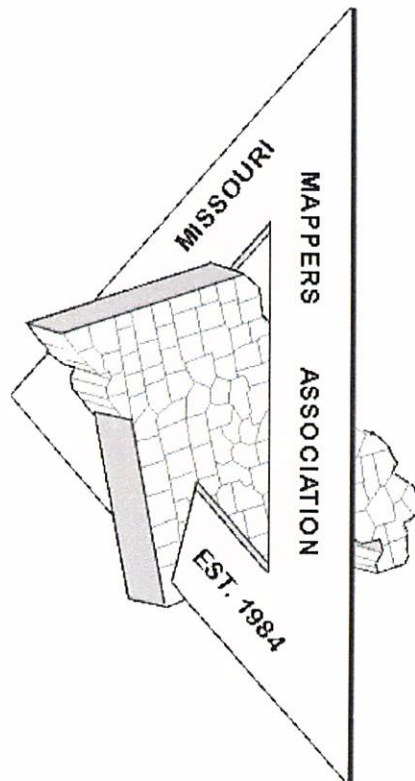
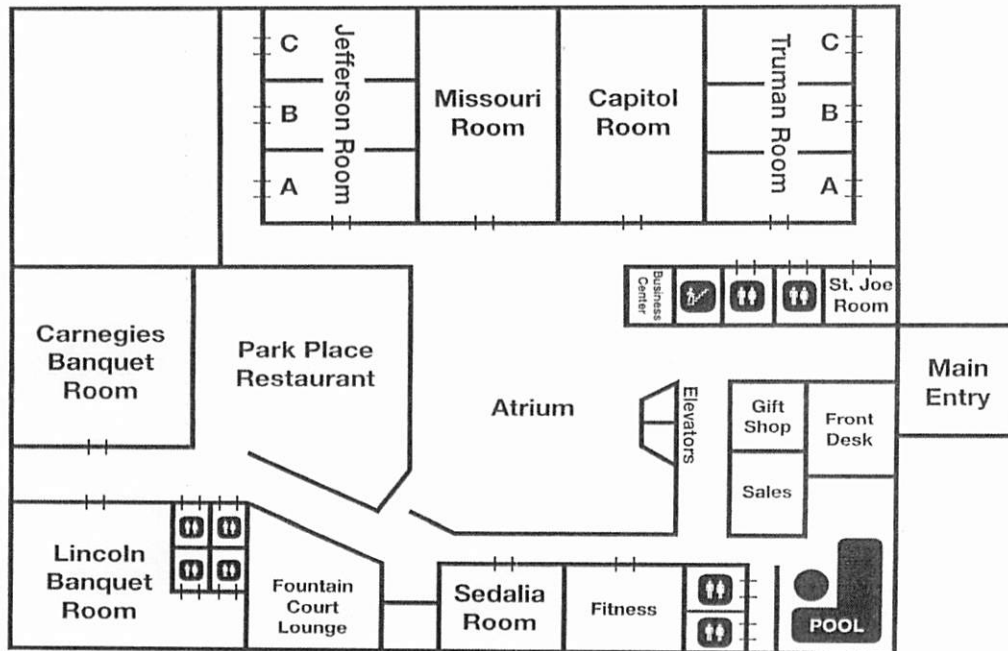

TABLE OF CONTENTS

2. Table of Contents
3. Hotel Map
4. Conference Schedule
5. Conference Schedule - cont.
6. Wednesday Workshops
7. Corporate Sponsorship
8. Thursday Presentations
9. Thursday Presentations - cont.
10. Exhibitors
11. Awards
12. Officers
13. Committees
14. MMA Membership List
15. MMA Membership List - cont.
16. MMA Membership List - cont.
17. MMA Membership List - cont.
18. MMA Chapter Map

Capitol Plaza Hotel

First Floor Map



Capitol Plaza Hotel

Second Floor Map

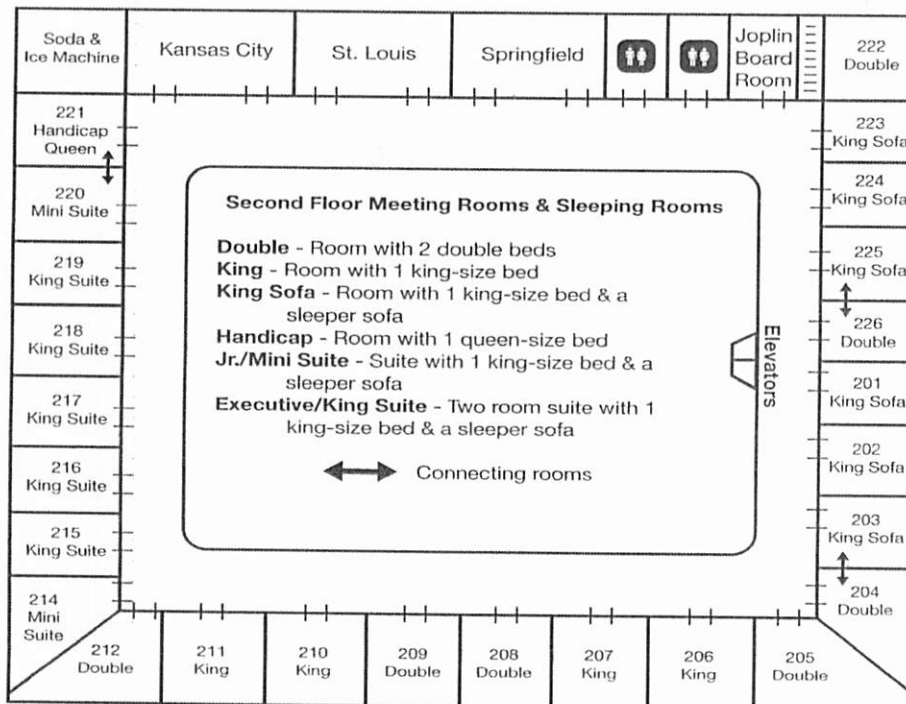

CONFERENCE SCHEDULE

Tuesday, August 1st

4:00 P.M. - 5:30 P.M.

Registration Open - Atrium

5:30 P.M. - 7:30 P.M.

Welcome Reception - Springfield Room
Food and non-alcoholic beverages provided

Wednesday, August 2nd

7:30 A.M. - 9:00 A.M.

Registration Open - Atrium

8:30 A.M. - 11:30 A.M.

Workshop - ArcGIS Online - Carnegies Room
Buster Schrage, GIS Manager, City of Jefferson

8:30 A.M. - 11:30 A.M.

Workshop - Riparian Rights and Other Challenging Issues - Lincoln Room
Matt Sorensen, Midland GIS Solutions

11:30 A.M. - 1:00 P.M.

Lunch on your own

1:00 P.M. - 4:00 P.M.

Workshop - Lifehacks: ArcGIS - Carnegies Room
Stacey Priest, Schneider Corporation

1:00 P.M. - 4:00 P.M.

Workshop - Geospatial Law - Lincoln Room
Christopher W. Dunn, Attorney and Counselor at Law

4:30 P.M. - 5:30 P.M.

Registration Open - Atrium

5:30 P.M. - 7:30 P.M.

Vendor Reception - Atrium

8:00 P.M. - 10:00 P.M.

2 Hour Prison Ghost Tour (transportation provided)

Thursday, August 3rd

7:30 A.M. - 8:00 A.M.

Registration Open - Atrium

7:30 A.M. - 8:30 A.M.

Breakfast Buffet - Truman Room

7:30 A.M. - 8:30 A.M.

PMM Breakfast - Springfield Room

9:00 A.M. - 9:45 A.M.

Presidential Welcome - Lincoln Room
Keynote Speaker: Shannon White, University of Missouri

9:45 A.M. - 10:30 A.M.

Influence Fabric - Lincoln Room
Buster Schrage, GIS Manager, City of Jefferson

10:30 A.M. - 10:45 A.M.

Morning Break with Exhibitors - Atrium

10:45 A.M. - 11:30 A.M.

Census Data - Lincoln Room
Matt Hesser, State Demographer, State of Missouri

11:30 A.M. - 12:15 P.M.

Jefferson City Cemetery Project - Lincoln Room
Jill Ryan, Lincoln University

12:15 P.M. - 1:30 P.M.

Lunch, Chapter Meetings, Prize Drawings - Truman Room

CONFERENCE SCHEDULE

1:30 P.M. - 2:30 P.M.	National Address Database Effort in Missouri - Lincoln Room Jason Warzinik, GISP, GIS Manager, Boone County
2:30 P.M. - 3:15 P.M.	Missouri State-wide Parcel Layer - Lincoln Room Tracy Schloss, State of Missouri, Office of Geospatial Information
3:15 P.M. - 3:30 P.M.	Afternoon Break with Exhibitors - Grand Ballroom Foyer
3:30 P.M. - 4:00 P.M.	IAAO CMS Designation - Lincoln Room Jarron Paronto, Designation Program Manager, IAAO
6:00 P.M. - 7:00 P.M.	Dinner - Truman Room
7:00 P.M. - 9:00 P.M.	Casino Night - Lincoln Room

Friday, August 4th

7:30 A.M. - 8:30 A.M.	Breakfast Buffet - Truman Room
9:00 A.M.	Annual Business Meeting - Truman Room Presentation of Awards, Election of Officers Special Conference Survey Participant Drawing



WEDNESDAY WORKSHOPS

MORNING - 8:30 - 11:30

ArcGIS Online - Buster Schrage, GIS Manager, City of Jefferson

Want to build your own WebGIS Portal? This workshop will cover the process of creating and setting up groups in your ArcGIS Online Organization (AGO), setting up your AGO dashboard, cover and explore the differences between private and public GIS data published to AGO, and conclude with the building of a web application that will utilize the data built in the previous steps.

Pre-requisites: Attendees should have working knowledge of ArcGIS Basic and their ESRI Organizational Account configured and setup prior to the workshop. If you are unsure if your Organizational Account is configured, feel free to contact myself or Jean Jeannotte with ESRI to assist.

Riparian Rights and Other Challenging Parcel Mapping Issues - Matt Sorensen, Midland GIS Solutions

This workshop will focus on mapping parcels along water boundaries, (e.g. rivers, lakes, and creeks). The State of Missouri has thousands of miles of river and lake shoreline. Mapping parcels along these water boundaries can sometimes be confusing and overwhelming. We will discuss riparian rights and how some of these water boundary mapping issues have been handled in various counties throughout the State. We will also take time to work "hands-on" on a few challenging water boundary mapping examples, the old fashioned way, on hardcopy example maps. If you can map it the old fashioned way, you can easily map it into your GIS. Engineering scales, protractors, and example maps, with corresponding deeds, will be provided as part of this workshop.

AFTERNOON - 1:00 - 4:00

Lifehacks: ArcGIS - Stacey Priest, GIS Specialist, The Schneider Corporation

By definition, a lifehack is a "...procedure or action that solves a problem, simplifies a task, reduces frustration, etc, in one's everyday life" (Collins English Dictionary). In this workshop we will explore the lifehacks for ArcGIS Desktop that my colleagues and I have found, and want to share with you to make your daily tasks more effective and efficient. If time, we may also take a peek into the world of ArcGIS Pro, which offers a whole new set of lifehack opportunities for your ArcGIS Desktop experience.

Geospatial Law - Christopher W. Dunn, Attorney and Counselor at Law

The law surrounding geospatial issues is complex and always evolving. This fast-paced 3 hour blitz through the current state of geospatial law is presented by a lawyer who actually uses ArcGIS 10.x in his business and law practice. With a focus on those issues of interest to government mappers, the course will cover these topics:

1. The State's open records act & geospatial data acts
2. Your liability & the legal protections of sovereign immunity
3. Can you copyright government-created geospatial data?
4. Crafting an artful geospatial data use license
5. Calculating defensible charges for your geospatial records

*Thank you to Bill Winston and Aaron Addison with Washington University
for providing laptops for these workshops!!*

**A SPECIAL THANKS TO OUR
2017 CORPORATE SPONSORS**



MIDLAND
GIS Solutions



solutions.seilerinst.com

SEILER

Providing Integrated Solutions since 1945



SURDEX
CORPORATION

THURSDAY PRESENTATIONS

Keynote Speaker (9:00-9:45)

Shannon White, University of Missouri

As the Geospatial Extension Specialist (GES) for the State of Missouri, Shannon works with local, regional, state and federal entities to promote, understand and research geospatial applications across many discipline areas. The GES role is part of a larger network of Geospatial Extension Specialists from multiple states who are actively working in our respective communities by promoting new partnerships, teaching new and advanced geospatial technology users alike, facilitating access to data, researching and testing new technologies, publishing informative websites, etc.

Additionally, she is the Coordinator of the Missouri Geographic Alliance, a geographic education outreach entity which is part of the National Geographic Alliance Network. The Missouri Geographic Alliance is dedicated to increasing geographic literacy and raising public awareness of geography's importance to citizens of Missouri. The Alliance accomplishes it's mission through professional development, advocacy, public outreach, strategic partnerships, and curricular materials development.

Influence Fabric (9:45-10:30)

Buster Schrage, GIS Manager, City of Jefferson

What influences a decision maker when spending capital improvement dollars? How can subjectivity be reduced in the process? The City of Jefferson City has put their extensive inventory of GIS data to work by designing a process that created an "Influence Fabric", followed by the benefits of creating an "Influence Fabric" for your organization.

Mapping Census Bureau Survey Data (10:45-11:30)

Matt Hesser, State Demographer, Missouri Office of Administration

Learn what data are available from the U.S. Census Bureau, how they differ, methods of access, and the limitations of survey data in spatial analysis. This presentation will include demonstrations of the American Fact Finder (AFF) application, the Bureau's new Census Enterprise Dissemination Services and Consumer Innovation (CEDSCI) application, the process of importing Census Bureau files into ArcMap, and things to consider when mapping survey results.

There's Something 21st Century about the Old City Cemetery (11:30-12:15)

Jill Ryan, Lincoln University

Old City Cemetery (also known as Fairview) is one of the oldest cemeteries in Cole County, Missouri, with the first recorded burial being on August 12, 1826. In order to preserve the biographical details and location that relates to more than 800 burials, the chair of the City of Jefferson Cemetery Resource Board painstakingly researched and compiled the interment details (luckily in digital format!). The City of Jefferson GIS department then partnered with Lincoln University to allow students to collect field locations (by GPS) of each of the interments. Their spatial data was joined to the biographical details using GIS, which gives a clear picture of "who is buried where". The data is to be shared publicly through a web platform that allows a "search" by interred name and location. Preserving names, details and location honors the memory of those buried in Old City Cemetery.

National Address Database Effort in Missouri (1:30-2:30)

Jason Warzinik, GISP, GIS Manager, Boone County

The USDOT-sponsored National Address Database Pilot Project concluded in July 2016 and included Arizona, Arkansas, and Boone County Missouri. The pilot is now complete and the NAD for Missouri has grown out of Boone County, and now includes over 1.3 million addresses. This session will provide a brief overview of the effort, key findings and recommendations, final data deliverables, issues identified by the project, and potential next steps in building an operational NAD for Missouri. Attendees will also learn the basics of how to create a local address database using a mixture of local and non-local seed data sources.

THURSDAY PRESENTATIONS

Putting Together the Pieces - Missouri State-wide Parcel Layer (2:30-3:15)

Tracy Schloss, State of Missouri, Office of Geospatial Information

The challenges to creating a complete state-wide parcel layer are well known. Although this information originates locally, there are business needs at the state level for this information, not just for one county, but for many. In the past, individual state agencies have taken on the responsibility of obtaining this information, each to satisfy their own business needs. The Office of Geospatial Information, within the Missouri Office of Administration, Information Technology Services has been asked to facilitate the acquisition of this data. State agency stakeholders are coming together to discuss a more centralized and shared environment.

IAAO CMS Designation (3:30-4:00)

Jarron Paronto, Designation Program Manager, IAAO

The purpose of the Cadastral Mapping Specialist (CMS) designation is to recognize professionalism and competency in cadastral mapping techniques that support proper valuation for tax purposes, property tax administration, and property tax policy.

IAAO members may use this designation in conjunction with the production of maps and other graphic images and objects that support property appraisal and assessment administration in accordance with IAAO's commitment to excellence.

GO



WITH YOUR MAPPING!

EXHIBITORS

ClearBasin Software Representative: Andy Terry

P.O. Box 5870
Springfield, MO 65801
Tel: 417-770-7709 Email: andy@clearbasin.com
www.clearbasin.com



Midland GIS Solutions Representatives: Katie Shepherd and Matt Sorensen

501 N. Market
Maryville, MO 64468
Tel: 660-562-0050 Email: shepherd@midlandgis.com
www.midlandgis.com



Seiler Instrument Company Representatives: Scott Smith, Joe Madej, and Carol Burnis

3433 Tree Court Ind. Blvd.
St. Louis, MO 63122
Tel: 314-968-2282 Email: ssmith@seilerinst.com
www.seilerinst.com



Springfield Blue Print Representative: Tiffany Rogers

219 E. Pershing St.
Springfield, MO 65806
Tel: 417-869-7316 Email: trogers@spfdbblue.com
www.spfdbblue.com



Surdex Corporation Representative: Tim Donze

520 Spirit of St. Louis Blvd.
Chesterfield, MO 63005
Tel: 636-368-4400 Email: timd@surdex.com
www.surdex.com



The Schneider Corporation Representative: Stacey Priest

8901 Otis Avenue
Indianapolis, IN 46216
Tel: 317-826-7100 Email: spriest@schneidercorp.com
www.schneidercorp.com



2016 AWARD WINNERS

Congratulations to each of our Award Winners in 2016 for their outstanding contribution to MMA!

Mapper of the Year

Tim Kean

Fireball

Sue Ann Stokes

Boss of the Year

Karissa Logan

Annual Meeting Award

Sue Ann Stokes

President Award

Melissa Johnson



2016 - 2017 MMA OFFICERS

PRESIDENT

Carla Palmer

Jasper County

cpalmer@jaspercounty.org

417-237-1042

IMMEDIATE PAST PRESIDENT

Melissa Johnson

Cole County

mjohnson@colecouny.org

573-634-8901

PRESIDENT ELECT

Brenda Dryer

Lawrence County

lcmoassessor@sofnet.com

417-546-7210

SECRETARY

Tonja Friend

Taney County

tonjaf@co.taney.mo.us

417-466-2831

TREASURER

Lisa Perry

Jasper County

lperry@jaspercounty.org

417-237-1013

2016 - 2018 DIRECTOR

James Theisen

Pettis County

gis@pettiscomo.com

660-827-4800

2016 - 2017 DIRECTOR

Sue Ann Stokes

McDonald County

sueann.stokes@mcdonaldcountymo.gov

417-223-7405

2016 - 2017 COMMITTEES

ANNUAL MEETING

Sue Ann Stokes - Chair

Brenda Dryer

Lisa Perry

Danielle Orf

Lisa Mendpara

Alice Lee

Carla Palmer

Lora Miller

AWARDS

Alice Lee - Chair

Tonja Friend

Laura Cole

Lisa Mendpara

CERTIFICATION

Alice Lee - Chair

Stan Balsman

Marti Suiter

Stephanie Hyder-Stevens

EDUCATION

Katrina Williams - Chair

Cyndee Schmidt

Heidi Scheffler

Arron Kettle

HISTORICAL

Katrina Williams - Chair

MEDIA

Sue Ann Stokes - Chair

Melissa Johnson

MEMBERSHIP

Marti Suiter - Chair

Stephanie Hyder-Stevens

Sarah Anderson

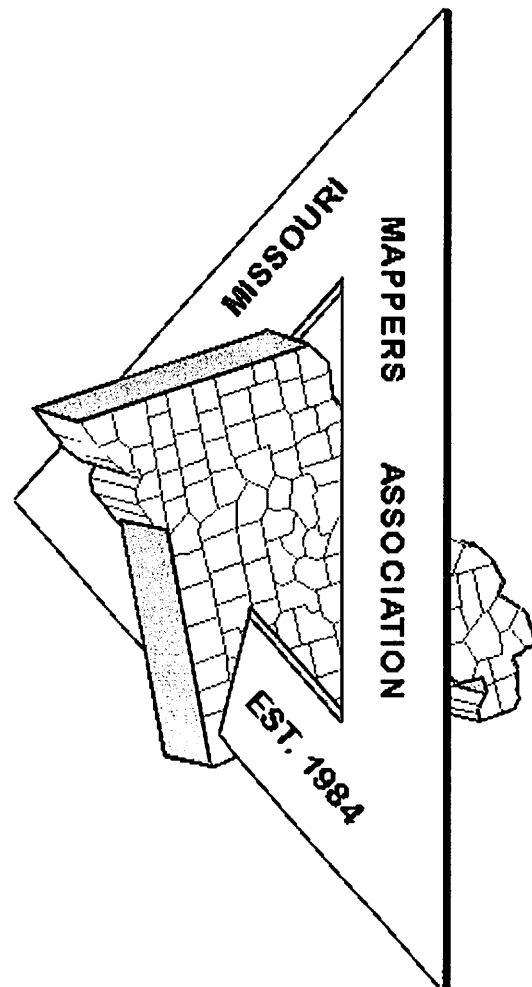

<u>Name</u>	<u>Entity</u>	<u>Phone</u>	<u>Email</u>
Adams, Bob	Cape Girardeau County	573-204-2522	badams@capecounty.us
Alexander, Patsy	Taney County	417-546-7210	patsya@co.taney.mo.us
Anderson, Sarah	Cape Girardeau County	573-204-2505	snanderson@capecounty.us
Armour, Kimberly	Ralls County	573-985-3292	rcmap@missouricom.com
Baker, Brian	Sidwell	630-549-1000	bbaker@sidwellco.com
Baker, Brett	Aerial Surveys International LLC		
Balsman, Stan	SEMO Regional Planning Commission	573-547-8357	sbalsman@semorpc.org
Bell, Amanda	Howell County		
Bishop, Kevin	Lincoln County	636-528-0321	kbishop@lincolngoassessor.com
Boggs, Diana	Pulaski County	573-774-4717	dboggs@pulcoassessor.com
Boltz, Celesta	Adair County	660-785-3245	cboltz@adaircomo.com
Bowden, Jennifer	Camden County		jennifer_gordon@camdenmo.org
Bowman, Doug	Lawrence County	417-466-2831	lcmoassessor@sofnet.com
Bowling, Leigh Anne	Johnson County E-911	660-422-6317	lbowling@joco911.org
Branum, Jerica	New Madrid County		jericabranum@newmadridcounty.net
Brown, Brian	Lincoln County	636-528-0321	bbrown@lincolngoassessor.com
Burnis, Carol	Seiler Instrument	314-968-2282	mapping@seilerinst.com
Bybee, Amanda	Trekk Design Group LLC		abybee@trekkdesigngroup.com
Calhoon, Norma Jean	Johnson County		ncalhoon@jocoassessor.com
Cantrell, Sheila	Webster County		sheila.cantrell@webster911.org
Cole, Laura	Jefferson County	636-797-6412	lcoble@jeffcomo.org
Cullen, Sandy	Camden County	573-346-3856	sandy_cullen@camdenmo.org
Davis, Jeff	Boone County	573-886-4262	jdavis@boonecountymmo.org
Donze, Tim	Surdex Corp	636-368-4400	timd@surdex.com
Dougherty, Conan	Greene County		cdougherty@greenecountymmo.org
Dryer, Brenda	Lawrence County	417-466-2831	lcmoassessor@sofnet.com
Duewell, Mark	UMC	573-882-6734	duewellm@missouri.edu
Edgar, Danny	St. Francois County		dedgar@sfcgov.org
Eisterhold, Cameron	Callaway Electric Cooperative		ceisterhold@callawayelectric.com
Evers, J Paul	Cole County	573-634-9132	pevers@colecouny.org
Fisher, Chase	Jasper County GIS		gis@jaspercounty.org
Forshee, David	City of Rolla	573-426-6957	dforshee@rollacity.org
Franks, Daniel	Howell County		assessorhowell@centurytel.net
Friend, Tonja	Taney County	417-546-7210	tonjef@co.taney.mo.us
Ghidotti, Paula	Jasper County	417-237-1036	pghidotti@jaspercounty.com

Glossip, Erin	Christian County	417-582-4310	eglossip@christiancountymo.gov
Gray, Danny	Christian County	417-582-4310	assessor@christiancountymo.gov
Henderson, Rae-Lyne	Johnson County		rhenderson@jocoassessor.com
Hennigan, Ann	Barry County	417-846-4911	gis@barrycountye911.org
Henry, Kayla	Camden County	573-317-3816	kayla_henry@camdenmo.org
Hoover, Connie	Jasper County	417-237-1036	jasperassessor@ecarthage.com
Houchin, Teresa	Scott County	573-545-3535	thsca@hotmail.com
Hunt, Eyvonne	Camden County	573-346-3990	eyvonne_hunt@camdenmo.org
Hyder-Stevens, Stephanie	MO State Tax Commission	417-468-3501	shyderstevens@hotmail.com
Ingram, Rena	Dunklin County	573-888-1409	renadianne@yahoo.com
James, Debbie	Texas County	417-967-4709	assessor@texascountymissouri.gov
Jens, David	Howell County		hcagis@centurytel.net
Johnson, Melissa	Cole County	573-634-8901	mjohnson@colecouny.org
Johnson, Jacob	New Madrid County		jacobjohnson@newmadridcounty.net
Jones, Larry	Buchanan County	816-271-3477	liones@co.buchanan.mo.us
Jones, Lori	Atchison County	660-744-2948	atchcoassessor@rpt.coop
Kallas, Mike	Tukuh Technologies, LLC		mike.kallas@tukah.com
Kaszuba, Barbara	Jasper County - retired		bakaszuba@gmail.com
Kean, Tim	Phelps County	573-458-6135	tim.kean@phelpscouny.org
Keitsenburg, Josh			jketzenburg@gmail.com
Kettle, Arron	Callaway County		ahudson@callawaycouny.org
Kramer, Richard	City of Jackson	573-243-2300	rkramer@jacksonmo.org
Krecic, Jeff	Tukuh Technologies, LLC	913-972-7092	jeff.krecic@tukah.com
Kysor, Teresa	Alliance Water		tkysor@cityofcapegirardeau.org
Largent, Scott	Henry County		scott.henrycoassessor@gmail.com
Lee, Alice	Jefferson County	636-797-6274	alee@jeffcomo.org
Lemmon, Rita	Polk County	417-326-4643	assessor5@polkcounyymo.org
Lenshyn, Becky	Camden County	573-346-4440	becky_lenshyn@camdenmo.org
Lloyd, Michael	Camden County E911	573-346-4440	m.lloyd@camdenco-mo.us
Logan, Karissa	Pettis County		pettisassessor@gmail.com
Lucky, Elizabeth	Johnson County E-911	660-422-6317	llucky@joco911.org
Madej, Joe	Seiler Instrument	314-968-2282	jmadej@seilerinst.com
McKinney, Christine	Pettis County	660-826-5000	mckinneyc@pettisco.com
Mendpara, Lisa	Cass County	816-380-8190	lisac@casscountymo.org
Miles, Elizabeth	Shelby County		shelbyassessor@marktwain.net
Miller, Laura	Vernon County	417-448-2530	lmiller@vernoncountymo.org

Morris, Shelby	Vernon County	417-448-2530	smorris@vernoncountymo.org
Noppe, Paula	Cape Girardeau County	573-204-2506	pnoppe@capecounty.us
Nordwald, Wendy	Warren County	636-456-8885	wnordwald@warrencountymo.org
Olive, Ken	Camden County	573-317-3811	ken_olive@camdenmo.org
Orf, Danielle	Pike County	573-324-3261	dno@pikecounty-mo.gov
Palmer, Carla	Jasper County	417-237-1042	cpalmer@jaspercounty.org
Paschal, Jody	Callaway County	573-642-0768	jody.paschal@yahoo.com
Perry, Lisa	Jasper County	417-237-1013	lperry@jaspercounty.org
Pope, Laura	McDonald County	417-223-2227	lspepe@olemac.net
Priest, Stacey	The Schneider Corporation		spriest@schneidercorp.com
Prior, Donna	Pike County	573-324-3261	dsp@pikecounty-mo.gov
Ragsdale, Regina	Randolph County	660-277-4716	
Reedy, Rodger	Benton County		county.assessor@bentoncomo.com
Reiter, JR	Camden County E911	573-346-4440	ir.reiter@camdenco-mo.us
Reynolds, Mark	Johnson County		mreynolds@jocoassessor.com
Ribble, Donna	Jefferson County	636-797-6273	dribble@jeffcomo.org
Rickman, Chris	Butler County		crickman@butlercountymo.com
Roe, Dan	State Tax Commission		dwroe@outlook.com
Rogers, Tiffany	Springfield Blue Print	417-869-7316	trogers@spfdblu.com
Scheffler, Heidi	Harry S Truman Coordinating Council	417-649-6400	hscheffler@hstcc.org
Schliefert, Judy	Benton County		judy.schliefert@bentoncomo.com
Schmidt, Cyndee	Kaysinger Basin Regional	660-885-3393	cschmidt@kaysinger.com
Schmitz, Patricia	Jefferson County	636-797-5473	pschmitz@jeffcomo.org
Scott, Mark	Laclede County		msscott12000@yahoo.com
Sears, Sherry	Barry County		ssearsbarryassessor@centurytel.net
Shepherd, Katie	Midland GIS Solutions	660-562-0050	shepherd@midlandgis.com
Simmons, Dana	Maries County		danas@mariesco.org
Smee, Tony	Cape Girardeau County	573-204-2519	tismee@capecounty.us
Smith, Gladys	St. Clair County	417-646-2449	glad@centurytel.net
Smith, Katie	Warren County	636-456-8885	wnordwald@warrencountymo.org
Smith, Scott	Seiler Instrument	314-968-2282	ssmith@seilerinst.com
Sorensen, Matt	Midland GIS Solutions	660-562-0050	sorensen@midlandgis.com
Starr, Todd			scatstarr@gmail.com
Stokes, Sue Ann	McDonald County	417-223-7405	sueann.stokes@mcdonaldcountymo.gov
Stone, Kevin	Randolph County		kevin.stone@randolphcounty-mo.gov
Suiter, Marti	Hickory County	417-327-7246	martsuiter@aol.com

Sullivan, Corey	Moniteau County	660-744-2948	addresser@moniteau911.com
Tetley, Courtney	Atchison County	660-827-4800	acassessor@atcomo.org
Theisen, James	Pettis County	660-277-4716	gis@pettisco.com
Tregnago, Richard	Randolph County	573-888-1409	richard.tregnago@randolphcounty-mo.gov
Vandiver, Karen	Dunklin County	816-892-1270	karendunkmo@yahoo.com
Vaughan, Ryan	City of Belton	573-680-1769	rvaughan@belton.org
Volkart, Diedra	Callaway County	573-756-1878	dvolkart@yahoo.com
Ward, Dan	St. Francois County		dward@sfcgov.org
Warmbrodt, Mike	Consolidated Electric Cooperative		mikew@consolidatedelectric.com
Waybill, Donnie	Adair County	660-665-4423	dwaybill@adaircomo.com
Wenzel, Kristen	Trekk Design Group LLC		kwenzel@trekkdesigngroup.com
Whittle, Daniel	Pulaski County	573-774-4717	dwhittle@pulcoassessor.com
Wideman, Frank	MU Natural Resources Engineer		widemanf@missouri.edu
Williams, Katrina	Capital Area Metropolitan Planning		kawilliams@jeffcitymo.org
Williams, Robin	Cedar County	417-276-6700	jwilliams13173@gmail.com
Willis, Jennie	Vanguard Appraisals, Inc	319-365-8625	jenniew@camavision.com
Wilson, Gaila	Camden County	573-346-4440	gaila_wilson@camdenmo.org
Winter, Aaron	Three Rivers Electric Cooperative		awinter@threeriverselectric.com
Witt, Darcey	ClearBasin Software	417-770-7709	darcey@clearbasin.com
Witt, Michael	ClearBasin Software	417-770-7709	michael@clearbasin.com
Witte, Carolyn	Audrain County		cwitte@audraincounty.org
Wollard, Kent	Ray County	816-776-2676	kwollard@raycocourthouse.com
York, Amy	Christian County	417-582-4310	ayork@christiancountymmo.gov
Zitterich, Joel	Vanguard Appraisals, Inc	319-365-8625	joelz@camavision.com

Missouri Mappers Association Chapters

Map date: July 14, 2016

