

Missouri Mappers Association

32nd Annual Conference

*The Magic of Mapping*

August 9th - 12th, 2016

Capitol Plaza Hotel & Convention Center

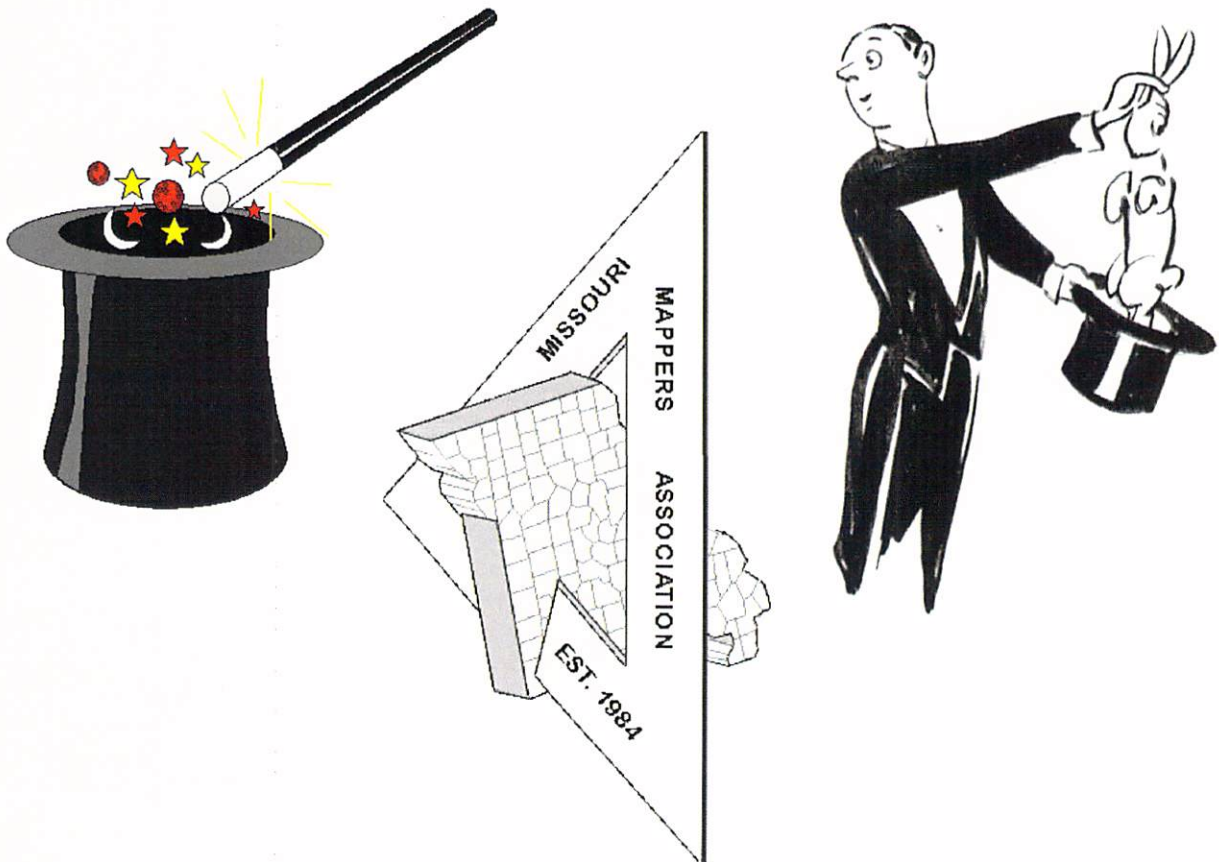

## **TABLE OF CONTENTS**

2. Table of Contents
3. Hotel Map
4. Conference Schedule
5. Conference Schedule - cont.
6. Wednesday Workshops
7. Corporate Sponsorship
8. Thursday Presentations
9. Thursday Presentations - cont.
10. Exhibitors
11. Awards
12. Officers
13. Committees
14. Membership photos
15. Membership photos - cont.
16. Membership photos - cont.
17. Membership photos - cont.
18. MMA Membership List
19. MMA Membership List - cont.
20. MMA Membership List - cont.
21. MMA Chapter Map

# Capitol Plaza Hotel

## First Floor Map

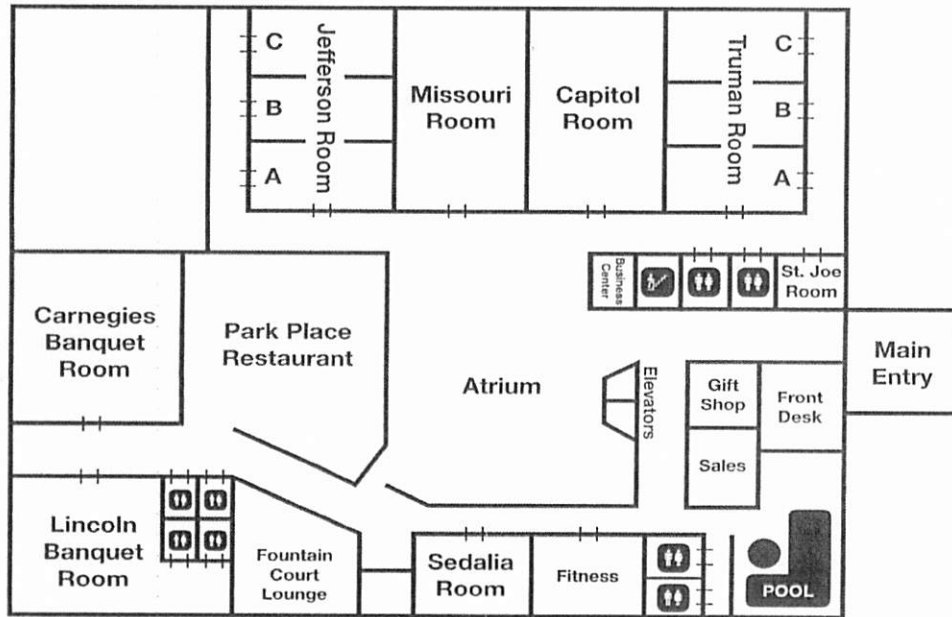

# Capitol Plaza Hotel

## Second Floor Map

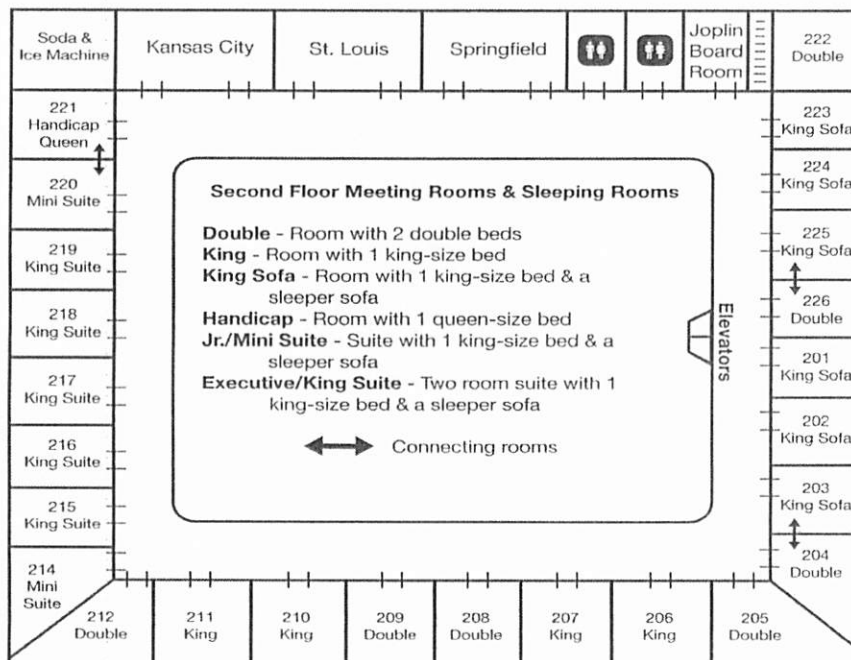

# CONFERENCE SCHEDULE

## **Tuesday, August 9th**

4:00 P.M. - 5:00 P.M.

Registration Open - Grand Ballroom Foyer

5:30 P.M. - 8:30 P.M.

Welcome Reception - Springfield Room  
Nacho bar and non-alcoholic beverages provided

## **Wednesday, August 10th**

7:30 A.M. - 9:00 A.M.

Registration Open - Grand Ballroom Foyer

8:30 A.M. - 11:30 A.M.

Workshop - ArcGIS Advanced Topics, Tips, and Tricks - Carnegies Room  
Josie Bock, ClearBasin Software

8:30 A.M. - 11:30 A.M.

Workshop - Riparian Rights and Other Challenging Issues - Lincoln Room  
Matt Sorensen, Midland GIS Solutions

11:30 A.M. - 1:00 P.M.

Lunch on your own

1:00 P.M. - 4:00 P.M.

Workshop - Beginning to Use gAMA - Carnegies Room  
Josie Bock, ClearBasin Software

5:00 P.M. - 7:00 P.M.

2 Hour Historical "More Talking, Less Walking" Prison Tour

6:00 P.M. - 7:30 P.M.

Registration Open - Grand Ballroom Foyer

7:30 P.M.

Vendor Reception - Jefferson Room

## **Thursday, August 11th**

7:30 A.M. - 9:00 A.M.

Registration Open - Grand Ballroom Foyer

7:30 A.M. - 8:30 A.M.

Breakfast Buffet - Jefferson Room

7:30 A.M. - 8:30 A.M.

PMM Breakfast - Sedalia Room

9:00 A.M. - 9:45 A.M.

Presidential Welcome - Lincoln Room  
Keynote Speaker: Michael Groose, Former MO State Penitentiary Warden

9:45 A.M. - 10:30 A.M.

The Role of The MO State Tax Commission - Lincoln Room  
Maureen Monaghan, State Tax Commission

10:30 A.M. - 10:45 A.M.

Morning Break with Exhibitors - Grand Ballroom Foyer

10:45 A.M. - 11:30 A.M.

Introduction to the NFIP & FEMA RiskMAP Program - Lincoln Room  
L. Scott Samuels, SEMA

11:30 A.M. - 12:15 P.M.

Field Data Collection Using ArcGIS Online - Lincoln Room  
Alexis M. Giesecker, State of Missouri

12:15 P.M. - 1:30 P.M.

Lunch, Chapter Meetings, Prize Drawings - Jefferson Room

1:30 P.M. - 2:30 P.M.

Deeds & Chain of Title Q&A - Lincoln Room  
David Townsend, Agents National Title Insurance Co

# CONFERENCE SCHEDULE

2:30 P.M. - 3:15 P.M.

Applied GIS for Economic Development - Lincoln Room  
Curtis Copeland, City of Branson

3:15 P.M. - 3:30 P.M.

Afternoon Break with Exhibitors - Grand Ballroom Foyer

3:30 P.M. - 4:15 P.M.

A Picture is Worth a Thousand Words - Lincoln Room  
Chet Hunter, Greene County Emergency Management

6:00 P.M.

Dinner and Magic Show - Jefferson Room

## **Friday, August 12th**

7:30 A.M. - 8:30 A.M.

Breakfast Buffet - Jefferson Room

9:00 A.M.

Annual Business Meeting - Lincoln Room  
Presentation of Awards, Election of Officers

*Abraçadabra!*

*Presto!*

*Hocus Pocus!*

# WEDNESDAY WORKSHOPS

## MORNING - 8:30 - 11:30

### **ArcGIS Advanced Topics, Tips, and Tricks - Josie Bock, ClearBasin Software**

This half day workshop will demonstrate various techniques such as advanced queries, editing, and analysis using the ArcGIS 10.3.1/10.4 software environment. We will also be going over tips and tricks that will hopefully help make your ArcGIS work easier.

Josie Bock, GISP, is currently the GIS Director for ClearBasin Software, LLC located in Springfield, MO. ClearBasin Software serves the county government tax and administration software market with web-enabled GIS solutions. With over 20 years of GIS experience in the industry, Josie is always happy to share her knowledge and support with those wanting to learn.

### **Riparian Rights and Other Challenging Parcel Mapping Issues - Matt Sorensen, Midland GIS Solutions**

This workshop will focus on mapping parcels along water boundaries, (e.g. rivers, lakes, and creeks). The State of Missouri has thousands of miles of river and lake shoreline. Mapping parcels along these water boundaries can sometimes be confusing and overwhelming. We will discuss riparian rights and how some of these water boundary mapping issues have been handled in various counties throughout the State. We will also take time to work "hands-on" on a few challenging water boundary mapping examples, the old fashioned way, on hardcopy example maps. If you can map it the old fashioned way, you can easily map it into your GIS. Engineering scales, protractors, and example maps, with corresponding deeds, will be provided as part of this workshop.

Matt Sorensen is the Sr. Vice President of Midland GIS Solutions. Matt has worked at Midland GIS since its inception in 2000, and has worked with over 50 counties with their parcel mapping GIS development. Matt obtained his Bachelors in Geography from Northwest Missouri State University in 1994, and has been a member of MMA for 14 years.

## AFTERNOON - 1:00 - 4:00

### **Beginning to Use gAMA (Appraiser and Mapping Tools) by ClearBasin Software - Josie Bock**

This workshop will help those who currently have or are interested in the gAMA software. We will be going over the uses and functionality built into the Appraiser and Mapping interfaces, how to tackle various kinds of parcel splits, adding improvements, and adjusting existing data.

A SPECIAL THANKS TO OUR  
2016 CORPORATE SPONSORS



**ClearBasin**



**MIDLAND**  
**GIS Solutions**



[solutions.seilerinst.com](http://solutions.seilerinst.com)

**SEILER**

*Providing Integrated Solutions since 1945*



**SURDEX**  
CORPORATION

# THURSDAY PRESENTATIONS

## **Keynote Speaker (9:00-9:45)**

**Michael Groose, Former Missouri State Penitentiary Warden 1990-1995**

Michael began his work with corrections in 1968, and retired with 32 years of service. He spent the majority of that time managing some facet of a correctional facility. He was in charge of custody of a 1,000 bed medium security facility in the 1980's. In 1990, he became the Warden of the Missouri State Penitentiary. He was promoted to a Deputy Director of Adult Prisons in 1995. In 2001, he was promoted to Director of Human Services for the Department of Corrections. This placed him in charge of the training of all correctional staff in the State, and all personnel functions. He has testified in the United States Federal Courts extensively in cases involving the Department of Corrections, conditions of confinement, policy and procedures, inmate treatment, etc. He has been accepted as an "Expert Witness" in the Federal Courts to testify in correctional cases before the court. From 1990-1999, he was a Professor at Columbia College teaching undergraduate and graduate level criminal justice and management classes in the evening program. Michael retired in 2002.

## **The Role of The Missouri State Tax Commission (9:45-10:30)**

**Maureen Monaghan, Chief Counsel, State Tax Commission**

This presentation will cover how the State Tax Commission and the Assessor's Offices are connected.

Maureen provides legal counsel for the three member Commission, presides over appeals submitted to the STC, manages the appraisal of railroad, pipeline, and utility properties, and provides information to Assessors, Collectors, and other County officials as well as the public in general. Maureen has served the STC since 2007. Prior to that, she was an Assistant Prosecuting Attorney for Cole County, Missouri. In that role, she not only handled prosecution of major felonies, but also served as counsel for county officials, and as the Juvenile Officer. Maureen graduated from the University of Missouri-Columbia Law School in 1989, after graduating from their School of Business in 1986. She currently resides in Jefferson City, Missouri with her husband Dave, and pets - Sammy Sosa the cat and Ernie Banks the dog. (Although the family pledges their allegiance to the St. Louis Cardinals, her son, rebelling, became a Cubs fan and named all the pets after Cubs players.) She has two children - Jane and Matt - who have graduated and are currently off the payroll.

## **Introduction to the NFIP and FEMA RiskMAP Program (10:45-11:30)**

**L. Scott Samuels, SEMA Floodplain Management Engineer**

This presentation will layout the basic NFIP requirements for community participation and the mapping products produced to support their membership, including the evolution of the Flood Insurance Rate Map (FIRM) product that is the basis for governing development in the regulatory floodplains.

Mr. Samuels has been active in the world of floodplain management since 1998. He has worked for the State of Missouri Emergency Management Agency (SEMA) as their Floodplain Management Engineer for over 7 years. He also operated a sole proprietorship consulting firm specializing in floodplain management issues for 11 years. He is active with the Missouri Floodplain and Stormwater Managers Associations (MfSMA) having served as an Area Director, Membership Secretary, and Chair of the Legislative Committee (not all at the same time). He earned a Bachelor's of Science Degree in Civil Engineering from Colorado State University, at Fort Collins, CO in 1988, and is a Registered Professional Engineer in Missouri, Maine, Ohio, and West Virginia.

## **Field Data Collection Using ArcGIS Online (11:30-12:15)**

**Alexis M Gieseke, GIS Specialist, State of Missouri**

Survey 123, Collector, and GeoForm oh my! This session will cover the differences and various ways to collect data utilizing the ArcGIS Online platform. We will conduct a hands on exercise so, BYOD - Bring Your Own Device.

Mrs. Gieseke has worked for the State of Missouri as a Geographical Information Systems Specialist for over 12 years. She earned a Bachelor of Arts Degree in Geography with an emphasis in Geographical Information Systems from University of Missouri, at Columbia, MO in 2005 and is a certified Geographical Information System (GIS) Professional, GISP.



# THURSDAY PRESENTATIONS

## **Deeds and Chain of Title Q & A (1:30-2:30)**

**David Townsend, Agents National Title Insurance Company**

Our most requested speaker is back again this year! This session will be a full hour devoted to answering your most perplexing deed and real estate title questions.

David A. Townsend is President and CEO of Agents National Title Insurance Company, a regional title insurance underwriter based in Columbia, Missouri. Agents National Title Insurance was founded to meet the needs of independent title agents. Mr. Townsend is a graduate of the University of Missouri School of Law, and Drury University, and has many years of experience in the areas of real estate and title law. Mr. Townsend is a speaker for the American Land Title Association, Missouri Land Title Association Title School, October Research Seminars, and other continuing education seminars. He is a member of the American Bar Association, the Missouri Bar Association, and the Missouri Department of Insurance Title Insurance Advisory Committee, Missouri Land Title Association, Indiana Land Title Association, Arkansas Land Title Association, Kansas Land Title Association, and the US Attorney's Mortgage Fraud Task Force for the Eastern District of Missouri. Mr. Townsend is the author of the Missouri Bar Insurance Practice Series: Title Insurance and the Missouri Bar Journal article Mechanics Lien Law: Section 429.016 establishes new notice requirements. Named the Missouri Land Title Young Title Professional for 2009, David was awarded the National Title Professional designation in 2013 by the American Land Title Association. David is married to Kerry Townsend, has one daughter, Blair and one son, Charlie, and lives in Columbia, Missouri.

## **Applied GIS for Economic Development (2:30-3:15)**

**Curtis Copeland, GIS Coordinator, City of Branson**

The City of Branson is currently undergoing a couple of major redevelopment and revitalization projects. The City has utilized a number of GIS applications, modeling, and analysis for project planning, decision making, and project tracking. This presentation will review some of those processes and models, and the tools used to create them.

Curtis is in his 18th year as the City of Branson GIS Coordinator. He really enjoys his career, and truly believes that GIS technology can be used to improve not only local government, but business, environment, healthcare....anything geographically related....which is almost everything! Curtis grew up in Springfield and Branson, attended Kickapoo High School, and graduated from MSU in 1997 with a degree in Geospatial Science.

## **A Picture is Worth a Thousand Words (3:30-4:15)**

**Chet Hunter, Emergency Management Director, Greene County Missouri**

This presentation will show how mapping definitely impacts many areas, especially Emergency Management. We currently use mapping to guide our decision making, understand impact, and capture recovery.

Chet Hunter was appointed Director of the Springfield-Greene County, Office of Emergency Management (OEM) in the summer of 2014. He is responsible for overall management of the Office of Emergency Management. He supervises all command staff personnel and maintains an ongoing capability to activate and support the Emergency Operations Center (EOC). Mr. Hunter has over 19 years of combined public safety experience. He has been part of the fire service (5 years), emergency medical services (13 years), 911 communications (3 years), and the emergency management field (8 years). Mr. Hunter received a Bachelor's Degree in Intercultural and Diversity Studies from Baptist Bible College, as well as Missouri Certified Emergency Manager through Missouri Emergency Managers Association (MOEMA), a licensed Emergency Medical Technician, and holds the Professional Development Series and Advanced Professional Development Series Certificates from FEMA. He also received a Masters Infrastructure Protection Certificate from Texas A&M Engineering Extension. Mr. Hunter is active in the Southwest Missouri Emergency Service Organization and is a member of the Southwest Missouri Incident Support Team (IST) as Logistics Section Chief. He also supports the Greene County Community Organization Active in Disasters as co-chair. In addition, he serves as President for the Missouri Emergency Management Association. Chet and his wife Cortney of 10 years have three children, and reside in the Greene County area.

# EXHIBITORS

**ClearBasin Software**     **Representatives: Darcey Witt and Michael Witt**

P.O. Box 5870  
Springfield, MO 65801  
Tel: 417-770-7709 Email: darcey@clearbasin.com  
www.clearbasin.com



**Midland GIS Solutions**     **Representatives: Katie Shepherd and Matt Sorensen**

501 N. Market  
Maryville, MO 64468  
Tel: 660-562-0050 Email: shepherd@midlandgis.com  
www.midlandgis.com



**Seiler Instrument Company**     **Representatives: Scott Smith, Joe Madej, and Carol Burnis**

3433 Tree Court Ind. Blvd.  
St. Louis, MO 63122  
Tel: 314-968-2282 Email: ssmith@seilerinst.com  
www.seilerinst.com



**Springfield Blue Print**     **Representative: Tiffany Rogers**

219 E. Pershing St.  
Springfield, MO 65806  
Tel: 417-869-7316 Email: trogers@spfdbblue.com  
www.spfdbblue.com



**Surdex Corporation**     **Representative: Tim Donze**

520 Spirit of St. Louis Blvd.  
Chesterfield, MO 63005  
Tel: 636-368-4400 Email: timd@surdex.com  
www.surdex.com



**The Schneider Corporation**     **Representative: Mark Barrie**

8901 Otis Avenue  
Indianapolis, IN 46216  
Tel: 317-826-7100 Email: mbarrie@schneidercorp.com  
www.schneidercorp.com



**Tukuh Technologies, LLC**     **Representative: Jeff Krecic**

1600 Genessee St., Ste 860  
Kansas City, MO 64102  
Tel: 913-972-7092 Email: mike.kallas@tukuh.com  
www.tukuh.com



# **2015 AWARD WINNERS**

Congratulations to each of our Award Winners in 2015 for their outstanding contribution to MMA!

## **Mapper of the Year**

Marti Suiter

## **Annual Meeting Award**

Brenda Dryer

## **President Award**

Richard Kramer Sr.



# 2015 - 2016 MMA OFFICERS

## PRESIDENT

Melissa Johnson  
Cole County  
mjohnson@colecouny.org  
573-634-8901

## IMMEDIATE PAST PRESIDENT

Richard Kramer Sr.  
City of Jackson  
rkramer@jacksonmo.org  
573-243-2300 ex. 33

## PRESIDENT ELECT

Carla Palmer  
Jasper County  
cpalmer@jaspercounty.org  
417-237-1042

## SECRETARY

Tonja Friend  
Taney County  
tonjaf@co.taney.mo.us  
417-466-2831

## TREASURER

Lisa Perry  
Jasper County  
lperry@jaspercounty.org  
417-237-1013

## 2015 - 2016 DIRECTOR

Brenda Dryer  
Lawrence County  
gagermann\_brenda64@yahoo.com  
417-546-7210

## 2015 - 2017 DIRECTOR

Sue Ann Stokes  
McDonald County  
sueann.stokes@mcdonaldcountymo.gov  
417-223-7405

# 2015 - 2016 COMMITTEES

## ANNUAL MEETING

**Sue Ann Stokes - Chair**

Brenda Dryer

Lisa Perry

Lisa Mendpara

Alice Lee

Carla Palmer

Lora Miller

## AWARDS

**Alice Lee - Chair**

Tonja Friend

Laura Cole

## CERTIFICATION

**Alice Lee - Chair**

Stan Balsman

Marti Suiter

## HISTORICAL

**Sue Ann Stokes - Chair**

Laura Pope

## MEDIA

**Sue Ann Stokes - Chair**

Melissa Johnson

Richard Kramer Sr.

## MEMBERSHIP

**Katie Shepherd - Chair**

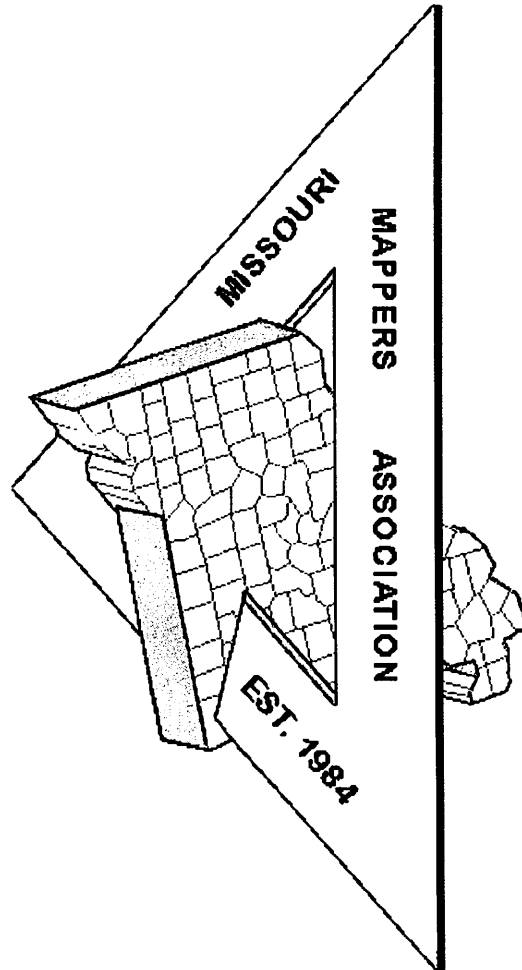





Sarah Anderson, Cape Girardeau County



Stan Balsman, SEMO Reg. Planning Comm.

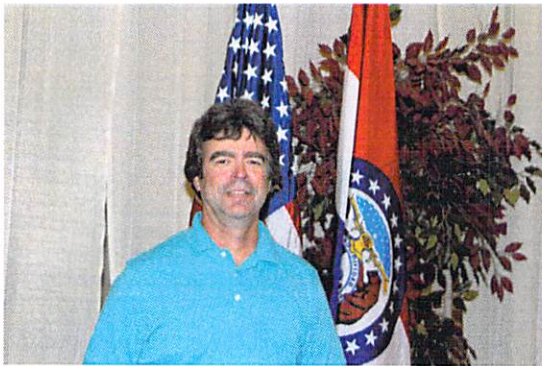

Doug Bowerman, Lawrence County



Brenda Dryer, Lawrence County



Tonja Friend, Taney County



Dustin Goodwin, Alliance Water



Stephanie Hyder-Stevens, MO STC



Jean Jeannotte, ESRI





Barbara Kaszuba, Jasper County



Tim Kean, Phelps County



Richard Kramer Sr., City of Jackson



Teresa Kysor, St. Charles County



Alice Lee, Jefferson County



Becky Lenshyn, Camden County



Lisa Mendpara, Cass County



Lora Miller, Vernon County





Kacie Neel, Pettis County



Paula Noppe, Cape Girardeau County



Belinka Novotny-Held, Jefferson County



Carla Palmer, Jasper County



Lisa Perry, Jasper County



Laura Pope, McDonald County



Amie Ragan, Saline County



Kay Schenewark, Benton County





Matt Sorensen, Midland GIS Solutions



Marti Suiter, Hickory County



Sandra Walter, Saline County



Eddie Whitworth, Camden County



Bill Wiggins, Phelps County



Robin Williams, Cedar County



Gaila Wilson, Camden County



<u>Name</u>	<u>Entity</u>	<u>Phone</u>	<u>Email</u>
Adams, Bob	Cape Girardeau County	573-204-2522	<a href="mailto:badams@capecounty.us">badams@capecounty.us</a>
Alexander, Patsy	Taney County	417-546-7210	<a href="mailto:patsya@co.taney.mo.us">patsya@co.taney.mo.us</a>
Anderson, Sarah	Cape Girardeau County	573-204-2505	<a href="mailto:snanderson@capecounty.us">snanderson@capecounty.us</a>
Armour, Kimberly	Ralls County	573-985-3292	<a href="mailto:rcmap@missouricom.com">rcmap@missouricom.com</a>
Baker, Brian	Sidwell	630-549-1000	<a href="mailto:bbaker@sidwellco.com">bbaker@sidwellco.com</a>
Balsman, Stan	SEMO Regional Planning Commission	573-547-8357	<a href="mailto:sbalsman@semorpc.org">sbalsman@semorpc.org</a>
Barrie, Mark	The Schneider Corporation	317-826-7100	<a href="mailto:mbarrie@schneidercorp.com">mbarrie@schneidercorp.com</a>
Bell, Amanda	Howell County		
Bishop, Kevin	Lincoln County	636-528-0321	<a href="mailto:kbishop@lincolngoassessor.com">kbishop@lincolngoassessor.com</a>
Boggs, Diana	Pulaski County	573-774-4717	<a href="mailto:dboggs@pulcoassessor.com">dboggs@pulcoassessor.com</a>
Boltz, Celesta	Adair County	660-785-3245	<a href="mailto:cboltz@adaircomo.com">cboltz@adaircomo.com</a>
Bowerman, Doug	Lawrence County	417-466-2831	<a href="mailto:lcmoassessor@sofnet.com">lcmoassessor@sofnet.com</a>
Bowling, Leigh Anne	Johnson County	660-422-6317	<a href="mailto:lbowling@joco911.org">lbowling@joco911.org</a>
Brown, Brian	Lincoln County	636-528-0321	<a href="mailto:bbrown@lincolngoassessor.com">bbrown@lincolngoassessor.com</a>
Burnis, Carol	Seiler Instrument	314-968-2282	<a href="mailto:mapping@seilerinst.com">mapping@seilerinst.com</a>
Calhoon, Norma Jean	Johnson County		<a href="mailto:ncalhoon@jocoassessor.com">ncalhoon@jocoassessor.com</a>
Cole, Laura	Jefferson County	636-797-6412	<a href="mailto:lcoble@jeffcomo.org">lcoble@jeffcomo.org</a>
Cullen, Sandy	Camden County	573-346-3856	<a href="mailto:sandy_cullen@camdenmo.org">sandy_cullen@camdenmo.org</a>
Davis, Jeff	Boone County	573-886-4262	<a href="mailto:jdavis@boonecountymo.org">jdavis@boonecountymo.org</a>
Donze, Tim	Surdex Corp	636-368-4400	<a href="mailto:timd@surdex.com">timd@surdex.com</a>
Dryer, Brenda	Lawrence County	417-466-2831	<a href="mailto:lcmoassessor@sofnet.com">lcmoassessor@sofnet.com</a>
Duewell, Mark	UMC	573-882-6734	<a href="mailto:duewellm@missouri.edu">duewellm@missouri.edu</a>
Evers, J Paul	Cole County	573-634-9132	<a href="mailto:pevers@colecouny.org">pevers@colecouny.org</a>
Forshee, David	City of Rolla	573-426-6957	<a href="mailto:dforshee@rollacity.org">dforshee@rollacity.org</a>
Franks, Daniel	Howell County		<a href="mailto:assessorhowell@centurytel.net">assessorhowell@centurytel.net</a>
Friend, Tonja	Taney County	417-546-7210	<a href="mailto:tonjaf@co.taney.mo.us">tonjaf@co.taney.mo.us</a>
Ghidotti, Paula	Jasper County	417-237-1036	<a href="mailto:pghidotti@jaspercounty.com">pghidotti@jaspercounty.com</a>
Glossip, Erin	Christian County	417-582-4310	<a href="mailto:eglossip@christiancountymo.gov">eglossip@christiancountymo.gov</a>
Gray, Danny	Christian County	417-582-4310	<a href="mailto:assessor@christiancountymo.gov">assessor@christiancountymo.gov</a>
Haney, Ashley	Hickory County		<a href="mailto:hickorycountvassessoradh@gmail.com">hickorycountvassessoradh@gmail.com</a>
Henderson, Rae-Lyne	Johnson County		<a href="mailto:rhenderson@jocoassessor.com">rhenderson@jocoassessor.com</a>
Hennigan, Ann	Barry County	417-846-4911	<a href="mailto:gis@barrycountye911.org">gis@barrycountye911.org</a>
Henry, Kayla	Camden County	573-317-3816	<a href="mailto:kayla.henry@camdenmo.org">kayla.henry@camdenmo.org</a>
Hoover, Connie	Jasper County	417-237-1036	<a href="mailto:jasperassessor@carthage.com">jasperassessor@carthage.com</a>
Houchin, Teresa	Scott County	573-545-3535	<a href="mailto:thsca@hotmail.com">thsca@hotmail.com</a>

Hunt, Eyvonne	Camden County	573-346-3990	<a href="mailto:eyvonne_hunt@camdenmo.org">eyvonne_hunt@camdenmo.org</a>
Hyder-Stevens, Stephanie	MO State Tax Commission	417-468-3501	<a href="mailto:shyderstevens@hotmail.com">shyderstevens@hotmail.com</a>
Ingram, Rena	Dunklin County	573-888-1409	<a href="mailto:renadianne@ymail.com">renadianne@ymail.com</a>
James, Debbie	Texas County	417-967-4709	<a href="mailto:assessor@texascountymissouri.gov">assessor@texascountymissouri.gov</a>
Jens, David	Howell County		
Johnson, Melissa	Cole County	573-634-8901	<a href="mailto:mjohnson@colecourt.org">mjohnson@colecourt.org</a>
Jones, Larry	Buchanan County	816-271-3477	<a href="mailto:ljones@co.buchanan.mo.us">ljones@co.buchanan.mo.us</a>
Jones, Lori	Atchison County	660-744-2948	<a href="mailto:atchcoassessor@rpt.coop">atchcoassessor@rpt.coop</a>
Kaszuba, Barbara	Jasper County		<a href="mailto:bakaszuba@gmail.com">bakaszuba@gmail.com</a>
Kean, Tim	Phelps County	573-458-6135	<a href="mailto:tim.kean@phelpscounty.org">tim.kean@phelpscounty.org</a>
Kramer, Richard	City of Jackson	573-243-2300	<a href="mailto:rkramer@jacksonmo.org">rkramer@jacksonmo.org</a>
Krecic, Jeff	Tukuh Technologies, LLC	913-972-7092	<a href="mailto:mike.kallas@tukuh.com">mike.kallas@tukuh.com</a>
Kysor, Teresa	St. Charles County	636-949-7900	<a href="mailto:tkysor@sccmo.org">tkysor@sccmo.org</a>
Lee, Alice	Jefferson County	636-797-6274	<a href="mailto:alee@jeffco.mo.org">alee@jeffco.mo.org</a>
Lemmon, Rita	Polk County	417-326-4643	<a href="mailto:assessor5@polkcountymo.org">assessor5@polkcountymo.org</a>
Lenshyn, Becky	Camden County	573-346-4440	<a href="mailto:becky_lenshyn@camdenmo.org">becky_lenshyn@camdenmo.org</a>
Lloyd, Michael	Camden County E911	573-346-4440	<a href="mailto:mike_lloyd@camdenmo.org">mike_lloyd@camdenmo.org</a>
Logan, Karissa	Pettis County		<a href="mailto:pettisassessor@gmail.com">pettisassessor@gmail.com</a>
Lucky, Elizabeth	Johnson County	660-422-6317	<a href="mailto:llucky@joco911.org">llucky@joco911.org</a>
Madej, Joe	Seiler Instrument	314-968-2282	<a href="mailto:mapping@seilerinst.com">mapping@seilerinst.com</a>
McKinney, Christine	Pettis County	660-826-5000	<a href="mailto:mckinneyc@pettiscountymo.com">mckinneyc@pettiscountymo.com</a>
Mendpara, Lisa	Cass County	816-380-8190	<a href="mailto:lisac@casscountymo.com">lisac@casscountymo.com</a>
Miller, Lora	Vernon County	417-448-2530	<a href="mailto:lmiller@vernoncountymo.org">lmiller@vernoncountymo.org</a>
Morris, Shelby	Vernon County	417-448-2530	<a href="mailto:smorris@vernoncountymo.org">smorris@vernoncountymo.org</a>
Moser, Arron	Callaway County	573-642-0768	<a href="mailto:ahudson@callawaycountymo.org">ahudson@callawaycountymo.org</a>
Noppe, Paula	Cape Girardeau County	573-204-2506	<a href="mailto:paulanoppe@capecountymo.us">paulanoppe@capecountymo.us</a>
Nordwald, Wendy	Warren County	636-456-8885	<a href="mailto:wnordwald@warrencountymo.org">wnordwald@warrencountymo.org</a>
Olive, Ken	Camden County	573-317-3811	<a href="mailto:ken.olive@camdenmo.org">ken.olive@camdenmo.org</a>
Orf, Danielle	Pike County	573-324-3261	<a href="mailto:dno@pikecountymo.gov">dno@pikecountymo.gov</a>
Palmer, Carla	Jasper County	417-237-1042	<a href="mailto:carlap226310@yahoo.com">carlap226310@yahoo.com</a>
Paschal, Jody	Callaway County	573-642-0768	<a href="mailto:jpaschal@callawaycountymo.org">jpaschal@callawaycountymo.org</a>
Perry, Lisa	Jasper County	417-237-1013	<a href="mailto:lperry@jaspercountymo.org">lperry@jaspercountymo.org</a>
Pope, Laura	McDonald County	417-223-2227	<a href="mailto:lslope@olemac.net">lslope@olemac.net</a>
Prior, Donna	Pike County	573-324-3261	<a href="mailto:dsp@pikecountymo.gov">dsp@pikecountymo.gov</a>
Ragsdale, Regina	Randolph County	660-277-4716	
Reiter, JR	Camden County E911	573-346-4440	<a href="mailto:greiter@1229@yahoo.com">greiter@1229@yahoo.com</a>



Reynolds, Mark	Johnson County	636-797-6273	<a href="mailto:mreynolds@jococourthouse.com">mreynolds@jococourthouse.com</a>
Ribble, Donna	Jefferson County	417-869-7316	<a href="mailto:dribble@jeffcomo.org">dribble@jeffcomo.org</a>
Rogers, Tiffany	Springfield Blue Print	417-649-6400	<a href="mailto:trogers@spfdblue.com">trogers@spfdblue.com</a>
Scheffler, Heidi	Harry S Truman Coordinating Council	660-885-3393	<a href="mailto:hscheffler@hstcc.org">hscheffler@hstcc.org</a>
Schmidt, Cyndee	Kaysinger Basin Regional	636-797-5473	<a href="mailto:cschmidt@kaysinger.com">cschmidt@kaysinger.com</a>
Schmitz, Patricia	Jefferson County		<a href="mailto:pschmitz@jeffcomo.org">pschmitz@jeffcomo.org</a>
Scott, Mark	Laclede County		
Sears, Sherry	Barry County		<a href="mailto:ssearsbarryassessor@centurytel.net">ssearsbarryassessor@centurytel.net</a>
Shepherd, Katie	Midland GIS Solutions	660-562-0050	<a href="mailto:shepherd@midlandgis.com">shepherd@midlandgis.com</a>
Smee, Tony	Cape Girardeau County	573-204-2519	<a href="mailto:tismee@capcountny.us">tismee@capcountny.us</a>
Smith, Gladys	St. Clair County	417-646-2449	<a href="mailto:glad@centurytel.net">glad@centurytel.net</a>
Smith, Katie	Warren County	636-456-8885	<a href="mailto:wnordwald@warrencountymmo.org">wnordwald@warrencountymmo.org</a>
Smith, Scott	Seiler Instrument	314-968-2282	<a href="mailto:ssmith@seilerinst.com">ssmith@seilerinst.com</a>
Sorensen, Matt	Midland GIS Solutions	660-562-0050	<a href="mailto:sorensen@midlandgis.com">sorensen@midlandgis.com</a>
Stokes, Sue Ann	McDonald County	417-223-7405	<a href="mailto:stokessue39@yahoo.com">stokessue39@yahoo.com</a>
Suiter, Marti	Hickory County	417-327-7246	<a href="mailto:martisuiter@aol.com">martisuiter@aol.com</a>
Tetley, Courtney	Atchison County	660-744-2948	<a href="mailto:acassessor@atcomo.org">acassessor@atcomo.org</a>
Theisen, James	Pettis County	660-827-4800	<a href="mailto:gis@pettisco.com">gis@pettisco.com</a>
Thomas, Bill	McDonald County 911	417-223-4640	<a href="mailto:bthomas@mc-911.org">bthomas@mc-911.org</a>
Thomas, Paula	McDonald County	417-223-4361	<a href="mailto:paula.thomas@mcdonaldcountymmo.gov">paula.thomas@mcdonaldcountymmo.gov</a>
Tregnago, Richard	Randolph County	660-277-4716	<a href="mailto:richard.tregnago@randolphcounty-mo.gov">richard.tregnago@randolphcounty-mo.gov</a>
Vandiver, Karen	Dunklin County	573-888-1409	<a href="mailto:karendunkmo@yahoo.com">karendunkmo@yahoo.com</a>
Vaughan, Ryan	City of Belton	816-892-1270	<a href="mailto:rvaughan@belton.org">rvaughan@belton.org</a>
Volkart, Diedra	Callaway County	573-680-1769	<a href="mailto:dvolkart@callawaycounty.org">dvolkart@callawaycounty.org</a>
Ward, Dan	St. Francois County	573-756-1878	<a href="mailto:dward@sfcgov.org">dward@sfcgov.org</a>
Waybill, Donnie	Adair County	660-665-4423	<a href="mailto:dwaybill@adaircomo.com">dwaybill@adaircomo.com</a>
Whittle, Daniel	Pulaski County	573-774-4717	<a href="mailto:dwhittle@pulcoassessor.com">dwhittle@pulcoassessor.com</a>
Williams, Katrina	Mid-MO Regional Planning Commission	573-657-9779	<a href="mailto:katrinawilliams@mmrpc.org">katrinawilliams@mmrpc.org</a>
Williams, Robin	Cedar County	417-276-6700	<a href="mailto:cedarassessor@windstream.net">cedarassessor@windstream.net</a>
Willis, Jennie	Vanguard Appraisals, Inc	319-365-8625	<a href="mailto:jenniew@camavision.com">jenniew@camavision.com</a>
Wilson, Gaila	Camden County	573-346-4440	<a href="mailto:gaila_wilson@camdenmo.org">gaila_wilson@camdenmo.org</a>
Witt, Darcey	ClearBasin Software	417-770-7709	<a href="mailto:darcey@clearbasin.com">darcey@clearbasin.com</a>
Witt, Michael	ClearBasin Software	417-770-7709	<a href="mailto:darcey@clearbasin.com">darcey@clearbasin.com</a>
Wollard, Kent	Ray County	816-776-2676	<a href="mailto:kwollard@raycocourthouse.com">kwollard@raycocourthouse.com</a>
York, Amy	Christian County	417-582-4310	<a href="mailto:ayork@christiancountymmo.gov">ayork@christiancountymmo.gov</a>
Zitterich, Joel	Vanguard Appraisals, Inc	319-365-8625	<a href="mailto:joelz@camavision.com">joelz@camavision.com</a>

Map date: July 14, 2016

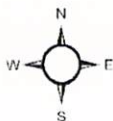
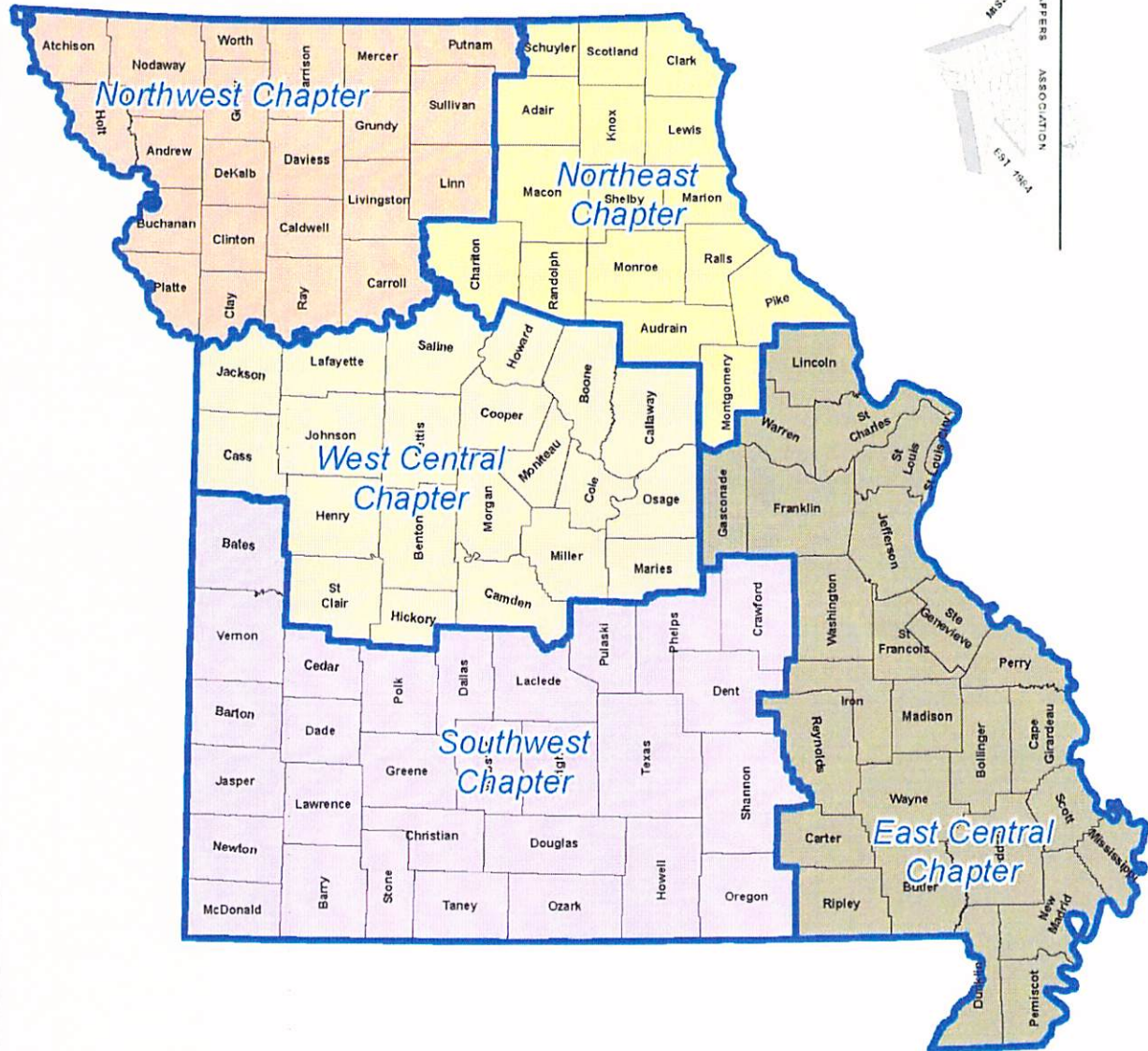

**THE MISSOURI MAPPERS ASSOCIATION  
APPRECIATES YOUR SUPPORT!  
SEE YOU NEXT YEAR!**

